

PB-HSTS



# HSTS TRAILER

Models HSTS30-RS-252B • HSTS30-RR-252B  
• HSTS45-SRS-324B

Owner/Operator's Manual  
&  
Parts Book

Starting 2020 Model Year

Reference Manual: See PB-ADR-B



11/17/2023

# 1.0 IMPORTANT INFORMATION

The serial number plate is riveted to the front left frame rail above the manual holder. Please enter the model, serial number and additional information in the space provided for future reference.



Model No. \_\_\_\_\_

Serial No. \_\_\_\_\_

Date of Purchase \_\_\_\_\_

Dealership \_\_\_\_\_

Dealership Phone No. \_\_\_\_\_

Always use your serial number when requesting information or when ordering parts.

## HOW TO READ THE SERIAL NUMBER

EXAMPLE: 20HSTS201

Model Year / Model / Sequence Of Build



20



HSTS



201

---

Meyer Manufacturing Corporation  
674 W. Business Cty Rd A  
Dorchester, WI 54425  
Phone: 1-800-325-9103  
Fax: 715-654-5513  
Email: [parts@meyermfg.com](mailto:parts@meyermfg.com)  
Website: [www.meyermfg.com](http://www.meyermfg.com)



## 2.0 PRE-DELIVERY & DELIVERY CHECK LIST

### MEYER MANUFACTURING CORPORATION

Phone: 715-654-5132 • Toll-Free: 1-800-325-9103 • P.O. Box 405 • Dorchester, WI 54425

This Pre-Delivery & Delivery Check List must be gone through by the Selling Party and the Customer to validate the Owner's Registration Form.

#### PRE-DELIVERY CHECK LIST

After the new Meyer HSTS Trailer has been completely set-up, check to be certain it is in correct running order before delivering it to the customer.

The following is a list of points to inspect:

**Check off each item as you have made the proper adjustments and found the item operating satisfactorily. Any adjustments made, MUST be according to specifications defined in this manual.**

- All shields and guards are in place and securely fastened.
- All bolts and other fasteners are secure and tight.
- All mechanisms operate trouble free.
- All grease fittings have been lubricated. Refer to 8.1 LUBRICATION.
- All decals are in place and legible.

#### DELIVERY CHECK LIST

The following check list is an important reminder of valuable information that **MUST** be passed on to the customer at the time the unit is delivered.

**Check off each item as you explain it to the customer.**

- Explain to the customer that pre-delivery check list was fully completed.
- Give customer the Owner & Operator's Manual. Instruct to read and completely understand its contents **BEFORE** attempting to operate the implement.
- Explain and review with customer the Implements manufacturer's warranty.
- Show the customer where to find the serial number on the implement.
- Explain and review with the customer the 5.1 SAFETY PRECAUTIONS.
- Explain and review with customer the proper "Start-up and Operating Procedures" sections of this manual.
- Demonstrate the start-up & shutdown controls, proper hydraulic hose storage and tip holder used to keep system clean from contaminants.
- Explain that regular lubrication and proper adjustments are required for continued proper operation and long life of the implement. Review with the customer the 8.1 LUBRICATION section of this manual.
- Fully complete this PRE-DELIVERY & DELIVERY CHECK LIST with the customer.



## 3.0 INTRODUCTION

*Congratulations on your purchase of a new Meyer farm equipment product. Undoubtedly you have given much consideration to your purchase and we're proud that you have selected Meyer. Pride in craftsmanship, engineering and customer service have made Meyer products the finest in the farm equipment industry today.*

*There is no substitute for quality. That is why thousands of people like you have purchased Meyer farm equipment. They felt it was the best equipment to serve their farming needs, now and in years to come. We ask that you follow our policy of "safety first", and we strongly suggest that you read through the "Owner / Operator's Manual & Parts Book" before operating your Meyer farm equipment. Meyer Manufacturing Corporation wants to thank you for not compromising quality. We are determined to offer excellence in customer service as well as provide you with the very best value for your dollar.*

*Sincerely,*

*All Employees of*

*MEYER MANUFACTURING CORPORATION*

---

The PB-ADR-B manual should be used in conjunction with this manual.

The HSTS Trailer may be referred to as equipment, machine or trailer in this manual.



**IMPORTANT:** You are urged to study this manual and follow the instructions carefully. Your efforts will be repaid in better operation and service as well as a savings in time and repair expense. Failure to read this manual and understand the machine could lead to serious injury. If you do not understand instructions in this manual, contact either your dealer or Meyer Manufacturing Corp. at Dorchester, WI 54425.



**WARRANTY:** At the front of this manual is an "Owner's Registration Form". Be sure your dealer has completed this form and promptly forwarded a copy to Meyer Manufacturing to validate the manufacturer's warranty. The product model and serial number are recorded on this form and on the inside of the front cover for proper identification of your Meyer implement by your dealer and the manufacturer when ordering repair parts. The serial number plate is located on the front left frame rail above the manual holder.



**REPAIR PARTS:** At the back of this manual is the repair parts section. All replacement parts are to be obtained from or ordered through your Meyer dealership. When ordering repair parts, refer to the parts section and give complete information including quantity, correct part number, detailed description and even model number and serial number of the implements which needs repair parts.

**Manufacturer's Statement:** Meyer Manufacturing Corporation reserves the right to make improvements in design, or changes in specifications at any time, without incurring any obligation to owners of units previously sold. This supersedes all previous published instructions.



## 4.0 MANUFACTURER'S WARRANTY

### MEYER HSTS TRAILER

5/2023

- I The "Owner's Registration Form" must be completed in full and promptly returned to Meyer Mfg. Corp. for this warranty to become both valid and effective. All warranties on new Meyer HSTS Trailers shall apply only to the original retail customer from an authorized Meyer Mfg. Corp. dealership.
- II This warranty shall not apply to any Meyer HSTS Trailer which has been subjected to misuse, negligence, alteration, accident, incorrect operating procedures, has been used for an application not designed for or pre-authorized by Meyer in writing, has had the serial numbers altered, or which shall have been repaired with parts other than those obtained through Meyer Mfg. Corp. Meyer is not responsible for the following: Depreciation or damage caused by normal wear, lack of reasonable and proper maintenance, failure to follow the operator's manual recommendations or normal maintenance parts and service. Meyer is not responsible for rental of replacement equipment during warranty repairs, damage to a power unit (including but not limited to a truck or tractor), loss of earnings due to equipment down time, or damage to equipment while in transit to or from the factory or dealer.
- III Meyer Mfg. Corp. warrants new Meyer Trailers to be free from defects in material and workmanship under recommended use and maintenance service, as stated in the "Owner / Operator's Manual and Parts Book", as follows:
  - A. Meyer Mfg. Corp. will repair or replace F.O.B. Dorchester, WI, as Meyer Mfg. Corp. elects, any part of a new Meyer Trailer which is defective in material or workmanship:
    - i Without charge for either parts or labor during the first (1) year from purchase date to the original retail customer.
    - ii Without charge for parts only during the second (2) year from purchase date to the original retail customer.
  - B. In addition to the above basic warranty, Meyer Mfg. Corp. will repair or replace F.O.B. Dorchester, WI as Meyer Mfg. Corp. elects:
    - i Any part of the following which is defective in material or workmanship (not neglect to recommended use and service) without charge for parts only (not labor) during the stated time periods from date of purchase to the original retail customer:
- IV COMMERCIAL USE: Coverage as in paragraph III.A.i. ONLY, except warranty coverage is for (90) days for parts and labor to the original commercial retail customer.
- V Repairs eligible for labor warranty must be made by Meyer Mfg. Corp. or an authorized Meyer dealership. The original retail customer is responsible for the transportation of the Meyer Trailer to the dealership for warranty service or for any service call expenses.
- VI Except as stated above, Meyer Mfg. Corp. shall not be liable for injuries or damages of any kind or nature, direct, consequential, or contingent, to persons or property. This warranty does not extend to loss of crop or for any other reasons.
- VII No person is authorized to give any warranties or to assume any other obligation on Meyer Mfg. Corp.'s behalf unless made or assumed in writing by Meyer Mfg. Corp. This warranty is the sole and exclusive warranty which is applicable in connection with the manufacture and sale of this product and Meyer Mfg. Corp's responsibility is limited accordingly.

#### **Purchased Product Warranty:**

This warranty does not apply to component parts not manufactured by Meyer such as but not limited to wheels, tires, tubes, PTO shafts, clutches, hydraulic cylinders, scales, tarps, etc.





## TABLE OF CONTENTS

1.0	IMPORTANT INFORMATION .....	2
2.0	PRE-DELIVERY & DELIVERY CHECK LIST .....	3
3.0	INTRODUCTION .....	5
4.0	MANUFACTURER'S WARRANTY .....	7
5.0	SAFETY .....	11
5.1	SAFETY PRECAUTIONS .....	12
5.1.1	TIRES .....	13
5.2	SAFETY SIGNS .....	14
5.3	SHUTOFF & LOCKOUT POWER .....	17
5.3.1	SHUTOFF & LOCKOUT POWER RECOMMENDATIONS .....	17
6.0	PRE-OPERATION .....	19
6.1	STATIC INSPECTION .....	19
6.2	HYDRAULIC HOOK-UP .....	20
6.3	HITCHING TO TRACTOR .....	21
6.3.1	JACK STORAGE .....	21
6.4	SET UP .....	22
6.5	START-UP AND SHUT-DOWN .....	23
6.5.1	START-UP .....	23
6.5.2	SHUT-DOWN .....	23
6.6	OPERATIONAL CHECKS .....	24
6.6.1	CONTROLS .....	25
6.6.1.1	HSTS30 .....	25
6.6.1.2	HSTS45 .....	25
6.7	TRANSPORTING .....	26
6.7.1	SAFETY CHAIN .....	27
6.7.2	TRACTOR TOWING SIZE REQUIREMENTS .....	28
6.7.3	BRAKE INFORMATION .....	28
6.7.4	LOCK-OUT STEERING INSTRUCTION (STEERING AXLE MODELS ONLY) ..	29
7.0	OPERATION .....	31
7.1	LOADING .....	31
7.2	UNLOADING .....	32
7.3	UNHOOKING THE TRACTOR .....	32

## TABLE OF CONTENTS

8.0	MAINTENANCE .....	33
8.1	LUBRICATION .....	33
8.1.1	DAILY LUBRICATION (EVERY 8-12 LOADS*).....	33
8.1.2	MONTHLY LUBRICATION (EVERY 260-300 LOADS*).....	34
8.2	FASTENER TORQUE SPECIFICATIONS .....	36
8.2.1	GENERAL TORQUE SPECIFICATIONS .....	36
8.2.2	WHEEL TORQUE REQUIREMENTS.....	38
8.3	TIRES.....	38
8.3.1	TIRE INFLATION.....	38
8.4	BRAKES.....	38
8.5	STORING THE IMPLEMENT .....	39
8.6	RETURN THE IMPLEMENT TO SERVICE.....	40
9.0	REPAIR PARTS .....	41
	HSTS30 TRAILER ASSEMBLY .....	42
	HSTS30 SLIDER FRAME ASSEMBLY.....	44
	HSTS30 HYDRAULIC LIFT FRONT HOSES .....	46
	HSTS30 HYDRAULIC LIFT .....	48
	HSTS30 HYDRAULIC LIFT MANIFOLD.....	50
	HSTS45 TRAILER ASSEMBLY .....	52
	HSTS45 HYDRAULIC LIFT .....	54
	RIGID AXLE.....	56
	STEERABLE AXLE.....	58
	HYDRAULIC SUSPENSION.....	60
	HSTS30-RS LOCK & STEER HYDRAULIC SYSTEM.....	62
	HSTS45-SRS LOCK & STEER HYDRAULIC SYSTEM .....	64
	HSTS30 HLC BRAKE HYDRAULIC SYSTEM.....	66
	HSTS30 HLC BRAKE MANIFOLD.....	68
	HSTS45 HLC BRAKE HYDRAULIC SYSTEM.....	70
	HSTS45 HLC BRAKE MANIFOLD.....	72
	HSTS30 CONTROL BOX ELECTRICAL .....	74
	HSTS45 CONTROL BOX ELECTRICAL .....	76
10.0	SPECIFICATIONS.....	79
	NOTES.....	81
11.0	MAINTENANCE RECORDS .....	83

## 5.0 SAFETY

The Meyer implement is manufactured with operator safety in mind. Located on the implement are various safety signs to aid in operation and warn of danger or caution areas. Pay close attention to all safety signs on the implement.

Carefully follow the operating and maintenance instructions in this manual and all applicable safety laws. Failure to follow all safety procedures may result in serious injury or death.

**Before attempting to operate this implement, read and study the following safety information. In addition, make sure that every individual who operates or works with the implement, whether family member or employee, is familiar with these safety precautions.**

**Meyer Mfg. Corp. provides guards for exposed moving parts for the operator's protection; however, some areas cannot be guarded or shielded in order to assure proper operation. The operator's manual and safety signs on the implement itself warn you of dangers and must be read and observed closely!**



### Safety Alert Symbol

This symbol is used to call attention to instructions concerning personal safety. Be sure to observe and follow these instructions. Take time to be careful!

---



**DANGER**

The signal word **DANGER** on the machine and in the manual identifies a hazardous situation which, if not avoided, WILL result in death or serious injury.



**WARNING**

The signal word **WARNING** on the machine and in the manual indicates a potentially hazardous situation which, if not avoided, COULD result in serious injury or death.



**CAUTION**

The signal word **CAUTION** on the machine and in the manual indicates a potentially hazardous situation which, if not avoided, MAY result in minor or moderate injury. It may also be used to alert against unsafe practices.

**IMPORTANT**

This notice identifies procedures which must be followed to avoid damage to the machine.

Danger, Warning, Caution, and instructional decals and plates are placed on the equipment to protect anyone working on or around this machine, as well as the components of the machine. All personnel operating or maintaining this equipment must familiarize themselves with all Danger, Warning, Caution, and instructional decals and plates.

## 5.1 SAFETY PRECAUTIONS

 **CAUTION**



**All individuals who will operate this implement must read and completely understand this Owner / Operator's and Parts Manual. Operator must receive instructions before operating the machine. Untrained operators can cause injury or death.**

- The PB-ADR-B manual should be used in conjunction with this manual.
- DO NOT allow anyone to operate, service, inspect or otherwise handle this implement until all operators have read and understand all of the instructional materials in this Operator's And Parts Manual and have been properly trained in its intended usage.
- Operator's must not use drugs or alcohol which impair alertness or coordination while working. An operator who is taking prescription drugs must get medical advice to determine if he or she can safely operate a machine and the equipment.
- Make sure all personnel can READ and UNDERSTAND all safety signs.
- DO NOT allow minors (children) or inexperienced persons to operate this implement.
- DO NOT operate until all shields and guards are in place and securely fastened.
- DO NOT step up on any part of the implement at any time.
- DO NOT adjust, clean or lubricate while the implement is in motion.
- Inspect when first delivered and regularly thereafter; that all connections and bolts are tight and secure before operating.
- Make certain everyone is clear of the implement before applying power.
- Keep hands, feet and clothing away from moving parts. Loose or floppy clothing should not be worn by the operator.
- Observe all applicable traffic laws when transporting on public roadways (where legal to do so). Check local laws for all highway lighting and marking requirements.
- Shut off and lock out power before adjusting, servicing, maintaining or clearing an obstruction from this machine. Refer to section 5.3 SHUTOFF & LOCKOUT POWER on page 17.
- Always enter curves or drive up or down hills at a low speed and at a gradual steering angle.
- Never allow riders on either tractor / truck or equipment.
- Keep tractor / truck in a lower gear at all times when traveling down steep grades.
- Maintain proper brake settings at all times.
- Use only properly rated undercarriage and tires.

## **Safety Precautions For Tractor Towed Units:**

- Do not exceed 20 mph (32 kph). Reduce speed on rough roads and surfaces.
- Always install a SMV emblem on pull-type equipment when transporting on roadways and keep clean and bright.
- Always yield to oncoming traffic in all situations and move to the side of the road so any following traffic may pass.
- Comply with state and local laws governing highway safety and movement of machinery on roadways.

## **Safety Precautions For Hydraulic System:**

- Check hydraulic tubes, hoses and fittings for damage and leakage. Never use hands to check for leaks. Hydraulic tubes and hoses must be properly routed and have adequate support and secure clamps. Tighten or replace any parts that show leakage.
- Always clean fluid spills. Do not use gasoline or diesel fuel for cleaning parts. Use commercial nonflammable solvents.

### **5.1.1 Tires**

#### **Recommended Safety Precautions**

- Always consult a professional tire service center for best safety practices before performing any work on a tire / wheel assembly.
- Always use the proper and approved tools to demount and mount the tire.
- Always inspect all rim / wheel parts for wear, damage, cracks, rust or mismatched components.
- Always destroy damaged or unserviceable parts.
- Always inspect the tire for side damage, cuts or wear. Unrepairable damaged items must be discarded.
- Always check for mismatched components or tire and wheel sizes.

#### **Non-Recommended Safety Precautions**

- Never re-inflate a tire that has been run flat or in an under inflated condition before removing and inspection.
- Never reuse damaged, defective, worn or mismatched parts.
- Never rework, weld, heat or braze any rim / wheel parts for any reason.

## 5.2 SAFETY SIGNS

# CAUTION

Read all safety signs on the implement and in this manual. Keep all safety signs clean and replace any damaged or missing safety signs before operating the equipment. Do not remove any safety signs. Safety signs are for operator protection and information.

FRONT HITCH

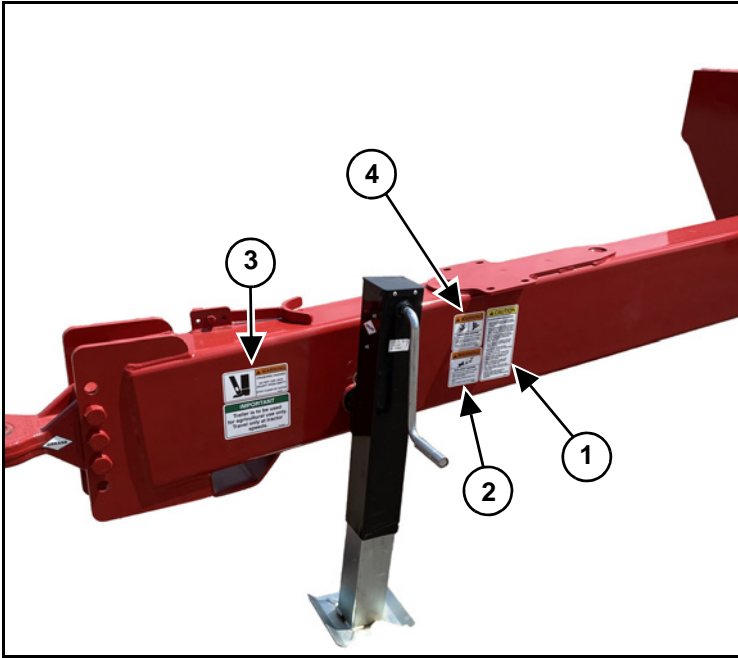

1

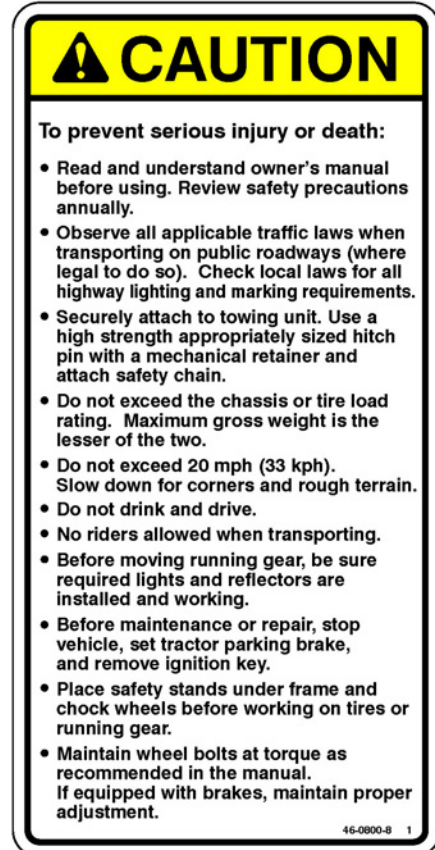

PART NO. 46-0800-8

3



PART NO. 46-3600-6

4



PART NO. 46-0800-6

2



PART NO. 46-0800-7

FRONT OF IMPLEMENT

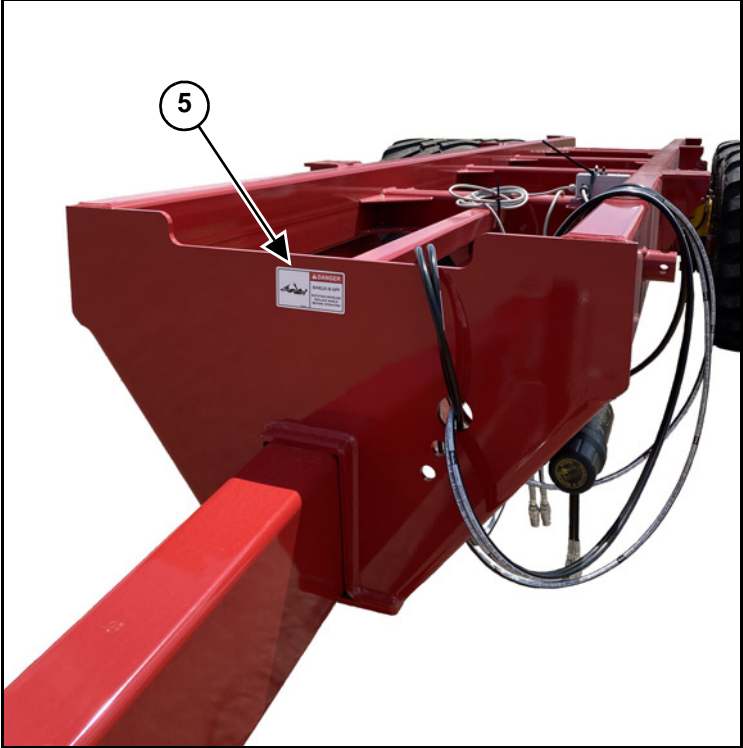

5



PART NO. 46-3600-2

LEFT SIDE OF IMPLEMENT

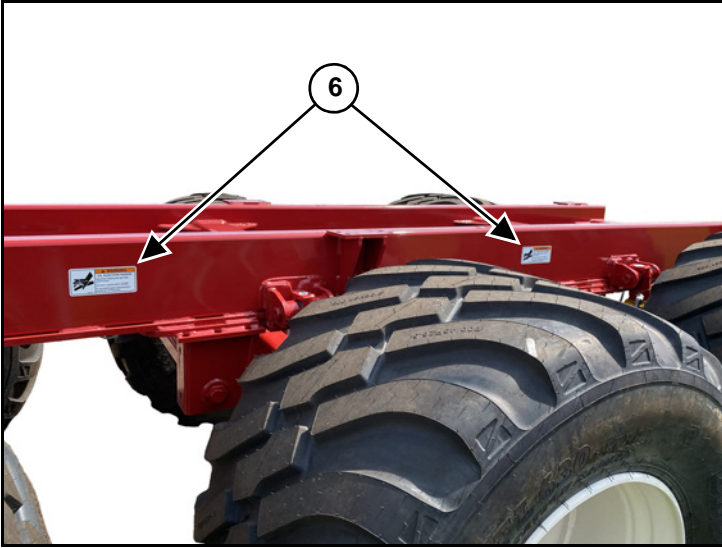

6

	<b>WARNING</b>
	<p><b>OIL INJECTION HAZARD</b></p> <p>RELIEVE PRESSURE BEFORE SERVICING.</p> <p>DO NOT CHECK WITH HANDS.</p> <p>IF INJURED SEEK EMERGENCY MEDICAL ATTENTION.</p>

PART NO. 46-8500-7  
(Both Sides)

LEFT SIDE OF IMPLEMENT (SLIDE AXLE MODEL ONLY)

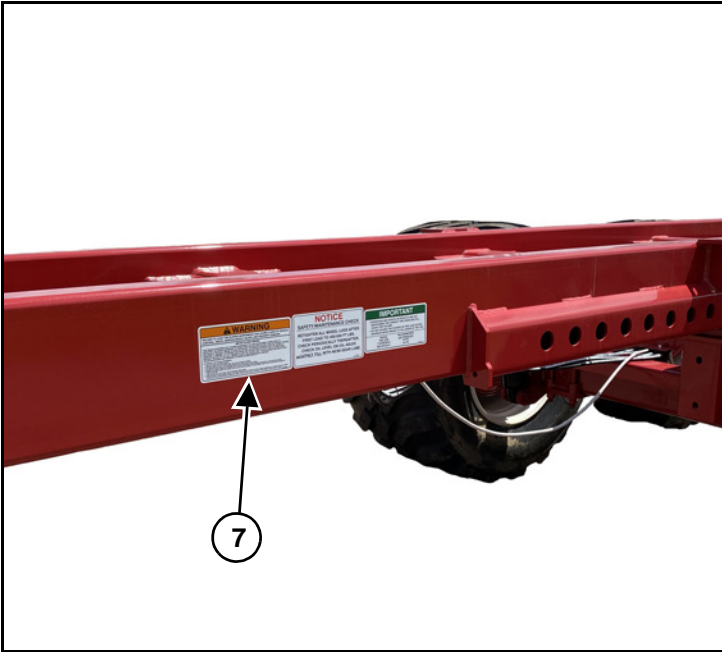

7

<b>WARNING</b>
<p>FAILURE TO LOCK THE SLIDING SUSPENSION CAN CAUSE A LOSS OF VEHICLE CONTROL, DEATH, SERIOUS BODILY INJURY, AND PROPERTY DAMAGE.</p>
<p style="text-align: center;"><b>MEYER SLIDER SERIES</b></p> <p>THIS TRAILER IS EQUIPPED WITH A SLIDING SUSPENSION THAT MUST BE SECURELY LOCKED PRIOR TO OPERATION. THE SLIDING SUSPENSION IS LOCKED WHEN THE MAIN BODY OF EACH LOCK PIN EXTENDS THROUGH THE HOLES IN THE RAILS. BEFORE PULLING THE TRAILER, THE SLIDING SUSPENSION MUST BE CAREFULLY INSPECTED TO ENSURE IT IS PROPERLY POSITIONED AND THE MAIN BODY OF EACH LOCK PIN DOES EXTEND THROUGH THE HOLE IN THE RAILS. BEFORE PULLING THE TRAILER, APPLY TRAILER BRAKES AND GENTLY ROCK TRAILER BACKWARDS AND FORWARDS TO ENSURE SLIDING SUSPENSION IS SECURE.</p> <p>TO POSITION THE SLIDING SUSPENSION:</p> <ol style="list-style-type: none"> <li>1. Set both tractor and trailer brakes.</li> <li>2. Remove locator bar from behind slider and move to desired location.</li> <li>3. To release the lock pins, pull operating handle all the way out and lock in place.</li> <li>4. Release the tractor brakes and carefully drive forward or backward until the sliding suspension is at the desired location.</li> <li>5. Release operating handle and visually check all lock pins for locking. The main body of each lock pin must extend through the holes in the rails.</li> <li>6. Lock locator bar in both body rails immediately behind slider.</li> <li>7. With the trailer brakes applied, gently rock trailer backward and forward to ensure sliding suspension is properly locked and follow procedures set out above before pulling the trailer. The lock pins must be checked at each stop to ensure each is locked.</li> </ol>

PART NO. 46-3000-2



## 5.3 SHUTOFF & LOCKOUT POWER



Any individual that will be adjusting, servicing, maintaining, or clearing an obstruction from this machine needs to ensure that this machine stays safely OFF until the adjustment, service, or maintenance has been completed, or when the obstruction has been cleared, and that all guards, shields, and covers have been restored to their original position. The safety of all individuals working on or around this machine, including family members, are affected. The following procedure will be referred to throughout this manual, so be familiar with the following steps.

### 5.3.1 Shutoff & Lockout Power Recommendations

1. Think, Plan and Check
  - a. **THINK** through the entire procedure and identify all the steps that are required.
  - b. **PLAN** what personnel will be involved, what needs to be shut down, what guards/shields need to be removed, and how the equipment will be restarted.
  - c. **CHECK** the machine over to verify all power sources and stored energy have been identified including engines, hydraulic and pneumatic systems, springs and accumulators, and suspended loads.
2. **Communicate** - Let everyone involved, including those working on or around this machine, that work is being done which involves keeping this machine safely “OFF”.
3. **Power Sources**
  - a. **LOCKOUT** - Shut off engines and take the key, or physically lock the start/on switch or control. Disconnect any power sources which are meant to be disconnected (i.e. electrical, hydraulic, and PTO of pull-type units).
  - b. **TAGOUT** - Place a tag on the machine noting the reason for the power source being tagged out and what work is being done. This is particularly important if the power source is not within your sight and/or will need to be isolated for a longer period of time.
4. **Stored Energy** - Neutralize all stored energy from its power source. Ensure that this machine is level, set the parking brake, and chock the wheels. Disconnect electricity, block movable parts, release or block spring energy, release pressure from hydraulic and pneumatic lines, and lower suspended parts to a resting position.
5. **Test** - Do a complete test and personally double check all of the above steps to verify that all of the power sources are actually disconnected and locked out.
6. **Restore Power** - When the work has been completed, follow the same basic procedures, ensuring that all individuals working on or around this machine are safely clear of the machine before locks and tags are removed and power is restored.

**IMPORTANT**

It is important that everyone who works on this equipment is properly trained to help ensure that they are familiar with this procedure and that they follow the steps outlined above. This manual will remind you when to SHUTOFF & LOCKOUT POWER.



## 6.0 PRE-OPERATION



Always keep all shields and guards in place and securely fastened. Keep hands, feet and clothing away from moving components.



**DO NOT** allow anyone to operate, service, inspect or otherwise handle this implement until all operators have read and understand all of the instructional materials in this Owner / Operator's and Parts Manual and have been properly trained in its intended usage.

**Verify that the implement is securely hitched to the tractor/truck.**

**Verify that all electrical/hydraulic connections and bolts/hardware are tight and securely fastened before operating the implement.**

**Wear safety glasses to prevent eye injury when any of the following conditions exist:**

- **When fluids are under pressure.**
- **Flying debris or loose material is present.**
- **Tools are being used.**

### 6.1 STATIC INSPECTION



**Hydraulic fluid escaping under pressure can have sufficient force to cause injury. Keep all hoses and connections in good serviceable condition.**

Before operating the implement for the first time and each time thereafter, check the following items:

1. Check that all safety signs are in good and legible condition.
2. Inspect the implement for proper adjustments.
3. Lubricate the equipment. (Refer to Section 8.1 LUBRICATION.)
4. Make sure that all guards and shields are in place, secured and functioning as designed.
5. Check condition of all hydraulic components for leaks. Repair or replace as required.
6. Inspect the condition of safety lighting. Repair or replace as required.
7. Be sure that there are no tools laying on the implement.
8. Verify that all electrical and hydraulic connections are tight and secure before operating.
9. Check that all hardware is in place and is tight.
10. Watch for any worn or cracked welds. If found, have qualified personnel repair immediately or replacement is necessary.
11. Check all bearings for wear. Replace as needed.
12. Check tires for proper inflation.
13. Check that the brakes are clean and clean them if necessary.

## 6.2 HYDRAULIC HOOK-UP



### WARNING

Hydraulic fluid escaping under pressure can have sufficient force to cause injury. Keep all hoses and connections in good serviceable condition.



### CAUTION

Shutoff and lockout power before adjusting, servicing, maintaining, or clearing an obstruction from this machine. Refer to section 5.3 SHUTOFF & LOCKOUT POWER.

Hydraulic input to the trailer should not exceed 3000 PSI. Call the factory for further information.

The PTO horsepower and/or hydraulic requirements may not reflect adequate tractor size for towing the machine.

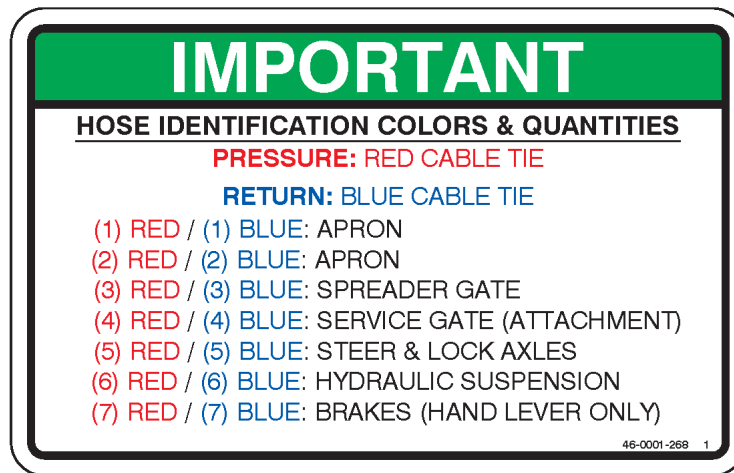

### **NOTES:**

- ***The hoses for the hydraulic suspension should be hooked up so that the operation of pulling back on the SCV lever raises the suspension and pushing forward on the SCV lever lowers the suspension.***
- ***With tractors that have limited SCVs: The Axle Lock-Unlock (Optional) can be left disconnected if it is not planned on being used. HSTS30 ONLY: The Hydraulic Suspension can be disconnected once Section 6.4 SET UP is completed.***

## 6.3 HITCHING TO TRACTOR



**WARNING**

Do not allow anyone to stand between the tongue or hitch and the tractor when backing up to the implement.

1. Measure the height of the tractor drawbar using a tape measure while on level surface.
2. Set implement hitch position according to the tractor drawbar height range.

**Note:** *If a different tractor is hitched to the box that has a different drawbar height, you will need to repeat these steps.*

Move to the operator's position, start the engine and release the parking brake.

Move the tractor in front of the implement. Slowly move the tractor backwards towards the implement and align the drawbar with the implement's hitch.

Lower or raise the trailer jack to properly align the drawbar and hitch.

Fasten the implement to the tractor drawbar with a properly sized hitch pin with safety retainer. (Reference ANSI/ASBE AD6489-3 Agricultural vehicles - Mechanical connections between towed and towing vehicles - Part 3: Tractor drawbar.)

Before operation and after hitching the tractor to the implement, connect the hydraulic hoses and control box power cord to the tractor.

**Note:** *HSTS45 models require two power cord connections to function properly.*

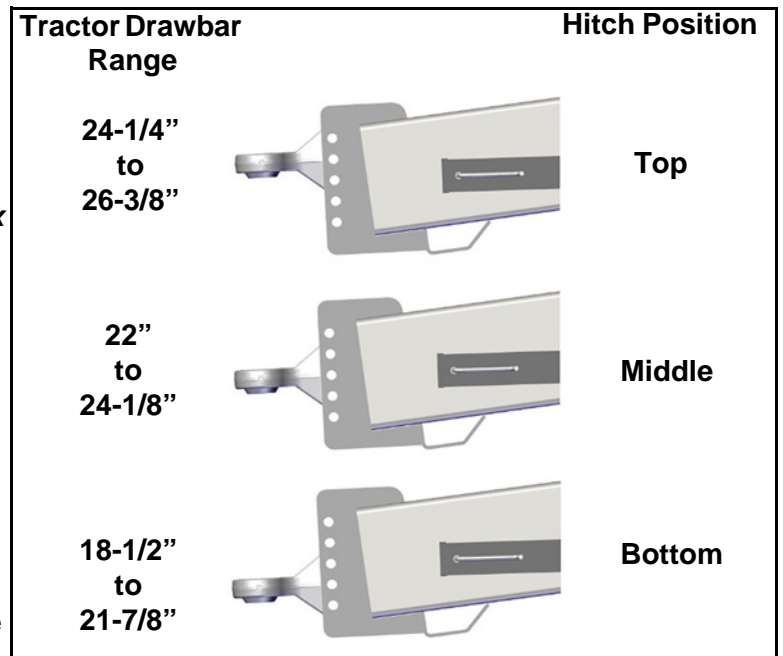

### 6.3.1 Jack Storage



**WARNING**

Jack is not designed to support the implement when it is loaded.

After hitching the trailer to the tractor.

Using the handle, raise the jack off the ground and remove the pin. Move the jack to the storage mount (Item 2) on the left hand frame rail of the trailer. Reinstall the pin to lock the jack into the transport position.

**Note:** *Keeping jack stored in proper position will keep it from getting damaged during transportation.*

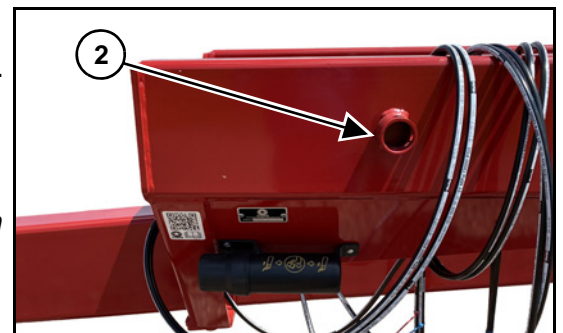

## 6.4 SET UP

### CAUTION

Shutoff and lockout power before adjusting, servicing, maintaining, or clearing an obstruction from this machine. Refer to section 5.3 SHUTOFF & LOCKOUT POWER.

DO NOT allow anyone to operate, service, inspect or otherwise handle this implement until all operators have read and understand all of the instructional materials in this Owner / Operator's and Parts Manual and have been properly trained in its intended usage.

Before operating the implement, look in all directions to ensure there are no bystanders, especially small children, in the work area.

Once the trailer is ready to be set up, follow the steps listed below:

1. Position trailer on level ground/surface.
2. **HSTS45 ONLY:** Turn the hydraulic suspension control box Master Power switch to ON, then switch the Automatic Lift Axle Mode to RUN.
3. Turn the control box rotary selector knob to LEVELING.
4. Lift or lower the hydraulic suspension using the tractor's SCV.
5. Have someone with a tape measure assist you in achieving a ride height of 45" from the ground to the trailer frame ahead of the lead trailer axle as shown in Figure 6.1 Trailer Height.
6. Turn the control box rotary selector knob to Run.
7. **HSTS45 ONLY:** Detent the hydraulic suspension SCV ON in the forward position to return to operation.

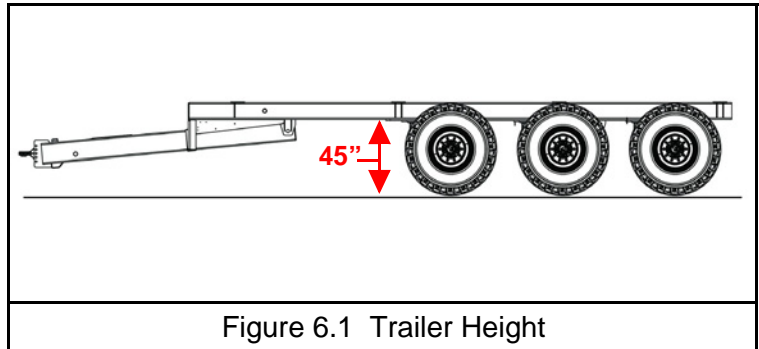

Figure 6.1 Trailer Height

## 6.5 START-UP AND SHUT-DOWN



Disengage electric/ hydraulic power, engage the machine's parking brake, stop the engine and make sure all moving components are completely stopped before connecting, disconnecting, adjusting or cleaning this equipment.

Always keep all shields and guards in place and securely fastened. Keep hands, feet and clothing away.



**DO NOT** allow anyone to operate, service, inspect or otherwise handle this implement until all operators have read and understand all of the instructional materials in this Owner / Operator's and Parts Manual and have been properly trained in its intended usage.

Before operating the implement, look in all directions to ensure there are no bystanders, especially small children, in the work area.

### 6.5.1 Start-Up



**HSTS45 ONLY:** If hydraulic suspension control box amber light is illuminated in RUN Mode, loss of traction could occur. Stop tractor and take immediate corrective action.

1. Enter the tractor and start the engine.
2. **HSTS45 ONLY:** Detent the hydraulic suspension SCV ON in the forward position.
3. **HSTS45 ONLY:** Turn the hydraulic suspension control box Master Power switch to ON, then switch the Automatic Lift Axle Mode to RUN.
4. Turn the hydraulic suspension control box rotary selector knob to RUN.
5. Operate at idle speed.

### 6.5.2 Shut-Down

1. Park the tractor on a flat, level surface.
2. **HSTS45 ONLY:** Turn the hydraulic suspension control box Automatic Lift Axle Mode to PARK, then switch the Master Power to OFF.
3. Disengage the hydraulics.
4. Engage the parking brake, stop the engine and exit the tractor.

## 6.6 OPERATIONAL CHECKS



**Make certain all personnel are clear of the implement before applying power.**



**Always keep all shields and guards in place and securely fastened.  
Keep hands, feet and clothing away from moving components.**



**Shutoff and lockout power before adjusting, servicing, maintaining, or clearing an obstruction from this machine. Refer to section 5.3 SHUTOFF & LOCKOUT POWER.**

**DO NOT allow anyone to operate, service, inspect or otherwise handle this implement until all operators have read and understand all of the instructional materials in this Owner / Operator's and Parts Manual and have been properly trained in its intended usage.**

**Before operating the implement, look in all directions to ensure there are no bystanders, especially small children, in the work area.**

Before operating the trailer for the first time and each time thereafter, follow the steps listed below.

1. Follow the Start-Up procedure in section 6.5.1 Start-Up.
2. Operate the trailer to verify all functionalities work properly.
3. Follow the Shut-Down procedure section 6.5.2 Shut-Down.
4. Check all hydraulic components for leaks.
5. Adjust and lubricate equipment as needed. See 8.1 LUBRICATION.



## 6.6.1 Controls

### 6.6.1.1 HSTS30

#### Axle Lift (Item 1)

- Not used.

**Note:** *Tandem axle trailers do not have lift axle functionality.*

#### Run (Item 2)

- Position rotary selector knob to RUN for normal operation.
- If the box is level when hitched, has the ride height set, and if no axle lift is needed, it is possible to disconnect the hydraulic suspension control box from its power source and the two hydraulic hoses from the tractor SCV.

#### Leveling (Item 3)

- Use this function to set the ride height of the suspension.

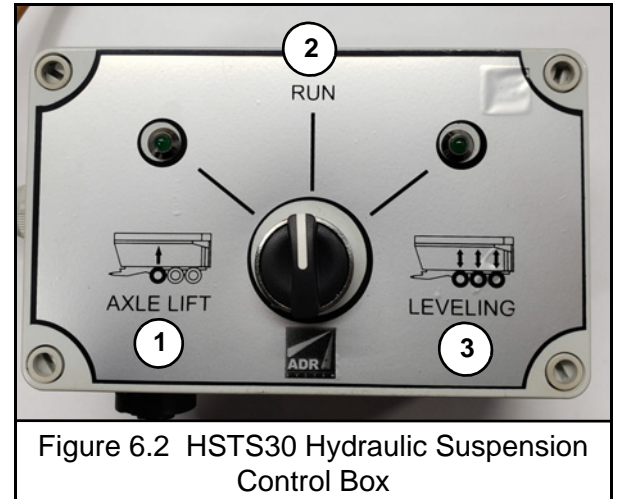

Figure 6.2 HSTS30 Hydraulic Suspension Control Box

### 6.6.1.2 HSTS45



**HSTS45 ONLY:** If hydraulic suspension control box amber light is illuminated in RUN Mode, loss of traction could occur. Stop tractor and take immediate corrective action.

#### Master Power (Item 1)

- Energizes the automatic lift axle system.

#### Automatic Lift Axle Mode (Item 2)

- Run Mode: This function automatically manages the weight on the tractor drawbar.
- Park Mode: This function locks the hydraulic suspension so the implement can be disconnected from the tractor drawbar.
- To activate, detent the hydraulic suspension SCV ON in the forward position. Turn the hydraulic suspension control box Master Power switch (Item 1) to ON, then switch the Automatic Lift Axle Mode (Item 2) to RUN. Turn the rotary selector knob to RUN (Item 3).

- If the control box amber light (Item 5) is illuminated, the automatic lift axle is inactive or set to PARK mode.

#### Run (Item 3)

- Position the rotary selector knob to RUN for normal operation.

#### Leveling (Item 4)

- Use this function to set the ride height of the suspension.

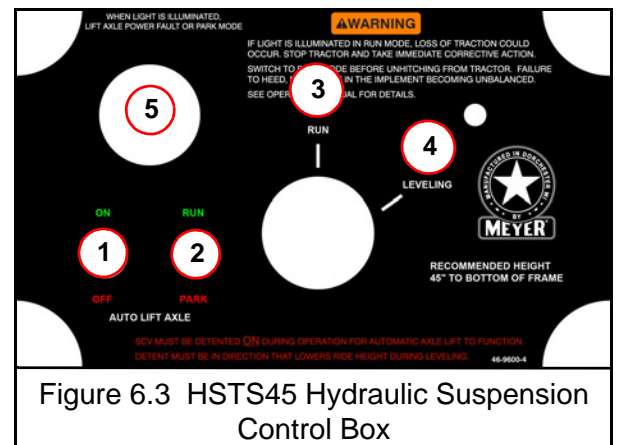

Figure 6.3 HSTS45 Hydraulic Suspension Control Box

## 6.7 TRANSPORTING

---

### CAUTION

- DO NOT allow anyone to operate, service, inspect or otherwise handle this implement until all operators have read and understand all of the instructional materials in this Owner/ Operator's and Parts Manual and have been properly trained in its intended usage.
  - Before operating the implement, look in all directions to ensure there are no bystanders, especially small children, in the work area.
  - No riders allowed when transporting.
  - Do not drink and drive.
  - Before moving, be sure required lights and reflectors are installed and working.
  - Before maintenance or repair, stop vehicle, set parking brake, and remove ignition key.
  - Place safety stands under frame and chock wheels before working on tires or chassis.
  - Maintain wheel bolts at torque as recommended in the manual.
  - If equipped with brakes, maintain proper adjustment.
- 

### CAUTION

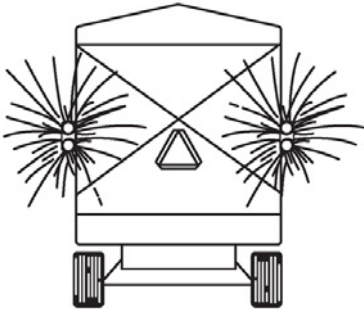

#### PULL-TYPE UNITS

- Use flashing warning lights when transporting on ALL highways (public roadways) at ALL times (Tractor towed models) EXCEPT WHEN PROHIBITED BY LAW! (Check w/local law enforcement).
  - Adhere to all state and federal laws. Implement lights do not replace the SMV (Slow-Moving Vehicle) identification emblem. All towed agricultural vehicles must display SMV emblems when traveling LESS than 20 mph (32 kph).
  - Check for traffic constantly. Be sure you can see that no one is attempting to pass you and that all traffic is sufficiently clear from you before making any turns.
  - Securely attach to towing unit. Use a high strength appropriately sized hitch pin with mechanical retainer and attach safety chain.
  - Do not exceed 20 mph (32 kph). Slow down for corners and rough terrain.
- 

### WARNING



- Keeps hands and body out of the hitch area when attaching towing vehicle
- Keep body clear of crush point between towing vehicle and load

## ! WARNING



- Shift to lower gear before going down steep grades
- Avoid traveling on slopes or hills that are unsafe
- Keep towing vehicle in gear at all times
- Never exceed a safe travel speed (may be less than 20 MPH)

## ! WARNING

You must observe all applicable traffic laws when transporting on public roadways. Check local laws for all highway lighting and marking requirements.

## ! WARNING

(Tractor Powered) Do not tow at speeds in excess of 20 mph.

## IMPORTANT

If you will travel on public roads and it is legal to do so, you must know all rules governing such operation. This will include lighting and brake requirements in addition to traffic rules.

**Note:** An optional highway lighting package is available to assist in meeting these requirements. See your Meyer dealer for details.

### 6.7.1 Safety Chain

The chain must be of adequate size to hold the weight of the loaded spreader.

**Note:** If using a grab hook at the end(s) of the chain to secure the chain to itself, a hook latch (Item 1) must be installed.

The length of the safety chain is not to be any longer than necessary to turn without interference. If any chain links or attachment hardware are broken or stretched, repair before using. Store chain so it does not corrode or become damaged. Do not use this chain for other implements because the strength and length of the chain may not be adequate. Identify this chain for use on this particular spreader.

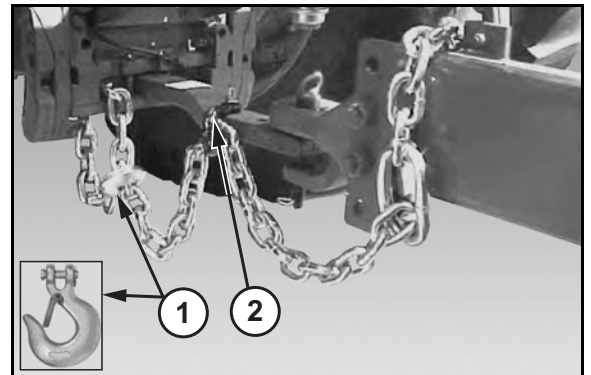

**Note:** Do not use the intermediate support (Item 2) as the attaching point.

## IMPORTANT

If you do not have a safety chain, or a replacement safety chain is needed, see your local Meyer dealer and do not operate on public roads until you are able to travel with the safety chain properly installed.

## 6.7.2 Tractor Towing Size Requirements

Use the following charts to help calculate the minimum tractor weight when towing without implement brakes. The minimum tractor weight, up to 20 mph (33 kph) needs to be two thirds of the box Gross Weight (GW). Gross Weight is calculated by the empty weight of the box and undercarriage combined added to the Load Weight. Then take the Gross Weight and multiply it by 0.667 and you will get the Minimum Required Weight of the Tractor.

**Note:** *Implement Loaded Weight x 0.667 = Minimum Tractor Weight Up to 20 mph*

Model	MAXIMUM IMPLEMENT GROSS WEIGHT (LBS)	MINIMUM TRACTOR WEIGHT UP TO 20 MPH (LBS)
HSTS30	48,000	32,000
HSTS45	90,000	60,000

## 6.7.3 Brake Information

Two brake systems are offered for your implement. A brake system is recommended for any implement operated on public roads and may be a requirement.

### 6.7.3.1 Lever Operated Hydraulic Brakes

**IMPORTANT**

When brakes are not required, the selector control valve lever must be in the “float” position.

This brake system is connected to the tractor remote hydraulic ports and is controlled by the tractor hydraulic system. The two hose system has a hydraulic manifold with pressure relief to prevent excessive pressure to the brake activating cylinders.

Applying hydraulic pressure from the tractor causes tractor hydraulic fluid to flow under pressure to the pressure relief valve which extends the brake cylinders to activate the brakes.

**Applying The Brakes** - Gradually move the tractor SCV (Selector Control Valve) lever as required to apply the brakes. The hydraulic hoses should be connected to the tractor ports so the SCV lever gives the expected response. Test this after hooking up. If response is opposite of expected, reverse the hoses.

**Releasing The Brakes** - Move the tractor SCV lever to the opposite direction and hold momentarily. Then return lever to the “Float” position.

**Note:** *Simply returning the SCV lever to the neutral position without first moving the lever to the opposite position, will not release the brakes.*

### 6.7.3.2 Pedal Operated Hydraulic Brakes

**CAUTION**

At no time should the brake system be used as a parking brake. With loss of hydraulic pressure, the brakes will lose their holding power.

This brake system is a one hose system. The single hydraulic hose must be connected to the tractor remote pedal port.

**Applying The Brakes** - Gradually apply the tractor brake pedal to apply the brakes.

**Releasing The Brakes** - Release the tractor brake pedal to release the brakes.

#### 6.7.4 Lock-Out Steering Instruction (Steering Axle Models Only)



Failing to lock steering on hillsides could cause loss of control.



Turning with steer axles locked may result in equipment damage.

- Steering should be locked out for any high-speed traveling, such as road traveling with a full load, and also when operating on steep side hills. Failing to lock the steering in either scenario may result in unintended sideways movement of the box or increased tire wear.
- Steering is locked out by activating the SCV for this circuit for approximately 5 seconds. The operator knows the steering has been locked out when the tires are seen straightening themselves. After the steer axle tires are straightened, the operator can release the SCV to the neutral position.
- Steering should be unlocked when turning.
- When the operator wishes to return the steering function of the axles, the SCV should be returned to the float position.
- Note that for normal operation the SCV for this circuit should always be in the float position.
- When reversing with steer axles, start by driving forward to align the tractor and implement to the line you plan on reversing to. Lock the steering axles and back the implement in a straight line to the desired location.



## 7.0 OPERATION

### CAUTION

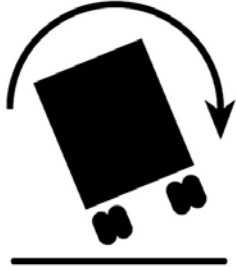

- **DO NOT** allow anyone to operate, service, inspect or otherwise handle this implement until all operators have read and understand all of the instructional materials in this Owner/ Operator's and Parts Manual and have been properly trained in its intended usage.
- Before operating the implement, look in all directions to ensure there are no bystanders, especially small children, in the work area.
- Do not climb or step on any part of the implement at any time.
- Turn on level ground. Slow down when turning.
- Go up and down slopes, not across them.
- Keep the heavy end of the machine uphill.
- Do not overload the machine.
- Check for adequate traction.

### 7.1 LOADING

### CAUTION

Shutoff and lockout power before adjusting, servicing, maintaining, or clearing an obstruction from this machine. Refer to section 5.3 SHUTOFF & LOCKOUT POWER.

### IMPORTANT

Overloading may cause failure of axles, tires, structural members, hitches, loss of vehicle control. **DO NOT** exceed maximum gross weight.

#### NOTES:

- *Overloading can have detrimental effects on the integrity of the implement and its safe use. Overloading will void the warranty and increase risk to the operator's safety. Always be aware of your gross weight.*
- ***HSTS45 ONLY:*** The red light (Item 1) at the front of the implement indicates when the automatic lift axle is transferring weight at the tractor drawbar.

Loading the trailer evenly from the front to rear will ensure there is downward force on the tractor hitch and provide traction for the tractor wheels.

If backing into the loading area is required and the trailer is equipped with steer axles, follow Section 6.7.4 Lock-Out Steering Instruction (Steering Axle Models Only) when backing up.

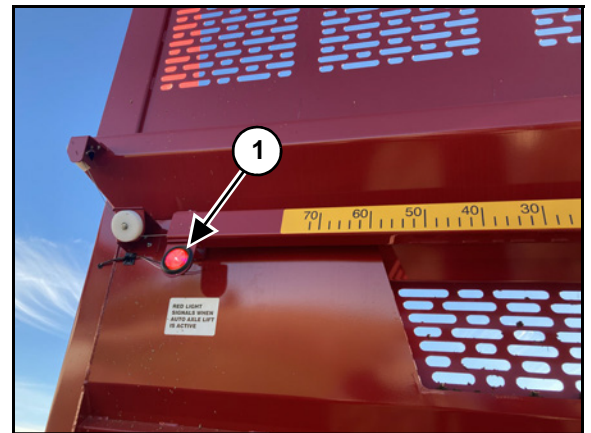

Figure 7.1 HSTS45 Active Lift Axle Indicator Light

MODEL	MAXIMUM TRAILER GROSS WEIGHT	TOTAL NET WEIGHT (LBS)
HSTS30	48,000	
HSTS45	90,000	

**NOTE:** Maximum Gross Weight is the lesser value between the implement or tires.

## 7.2 UNLOADING

### **WARNING**

**HSTS45 ONLY:** If hydraulic suspension control box amber light is illuminated in RUN Mode, loss of traction could occur. Stop tractor and take immediate corrective action.

### **CAUTION**

Shutoff and lockout power before adjusting, servicing, maintaining, or clearing an obstruction from this machine. Refer to section 5.3 SHUTOFF & LOCKOUT POWER.

**NOTE: HSTS45 ONLY:** The red light (Item 1) at the front of the implement indicates when the automatic lift axle is transferring weight at the tractor drawbar.

If any high-speed traveling, such as road traveling with a full load, is required, follow Section 6.7.4 Lock-Out Steering Instruction (Steering Axle Models Only). Steering axles should also be locked when operating on steep sidehills. Failure to lock the steering in either scenario may result in unintended sideways movement of the box or increased tire wear.

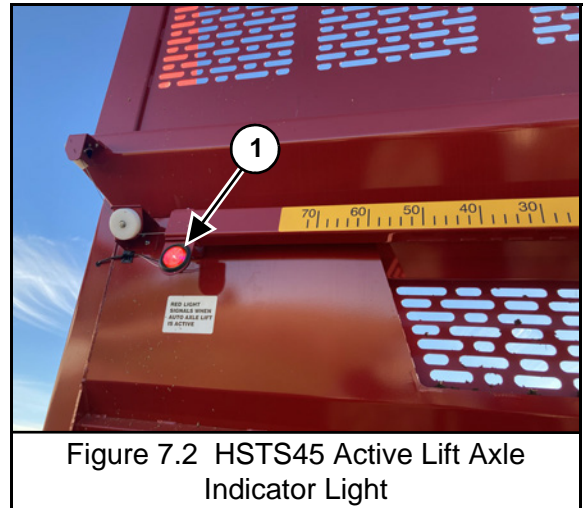

## 7.3 UNHOOKING THE TRACTOR

### **WARNING**

**HSTS45 ONLY:** Switch the hydraulic suspension control box to PARK Mode before unhitching from tractor. Failure to heed, may result in the implement becoming unbalanced.

Jack is not designed to support the implement when it is loaded.

1. Park the implement on level ground. Put the tractor controls in neutral, set the parking brake.
2. **HSTS45 ONLY:** Turn the hydraulic suspension control box Automatic Lift Axle Mode to PARK, then switch the Master Power to OFF.
3. Disengage the hydraulics.
4. Dismount tractor. Place wheel chocks in front and in back of the implement wheels on opposite sides to prevent the implement from rolling after the tractor is unhooked.
5. Remove the hydraulic hose ends from the tractor hydraulic ports and secure the hose ends in a proper manner as to keep them clean.
6. Disconnect trailer control box from tractor.
7. Remove the jack from the storage mount and install it on the hitch tongue. Crank the jack down until the hitch lifts off the tractor draw bar.
8. Remove the hitch pin.
9. Unhook safety chain from tractor drawbar and intermediate support.
10. Slowly drive the tractor away from the implement.



## 8.0 MAINTENANCE

### 8.1 LUBRICATION



Shutoff and lockout power before adjusting, servicing, maintaining, or clearing an obstruction from this machine. Refer to section 5.3 SHUTOFF & LOCKOUT POWER.

### IMPORTANT

Fluid such as hydraulic fluid, grease, etc., must be disposed of in an environmentally safe manner. Some regulations require that certain spills and leaks on the ground must be cleaned in a specific manner. See local, state and federal regulations for the correct disposal.

The PB-ADR-B manual should be used in conjunction with this manual.

#### NOTES:

- *Use a grease type that is composed of a high quality lithium complex or better, unless otherwise stated. We recommend using a #1 grade in colder temperatures or a #2 grade in warmer temperatures.*
- *We recommend using a 4-jaw grease coupling to allow greasing of both imperial and metric style grease fittings.*

See the PB-ADR-B manual recommendations to properly lubricate axle and hydraulic suspension components.

#### 8.1.1 Daily Lubrication (Every 8-12 Loads\*)

**NOTE:** *\*Estimating 5 minutes of run time per load.*

- Grease the hitch while rotating the ball bearing (Item 1) (both sides).

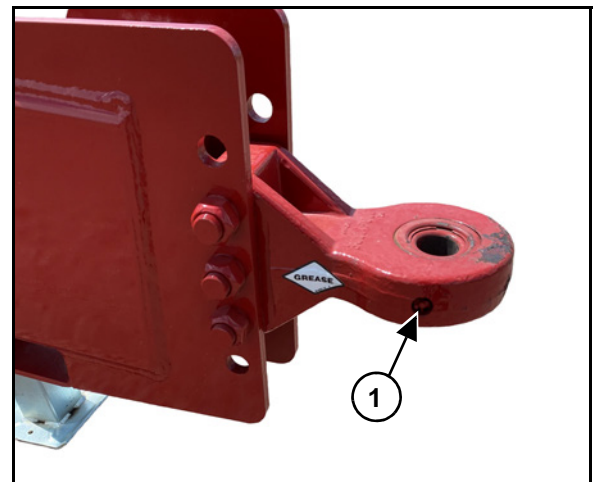

Hitch Lubrication Locations

### 8.1.2 Monthly Lubrication (Every 260-300 Loads\*)

**NOTE:** \*Estimating 5 minutes of run time per load.

- Grease (2) jack assembly zerks (Item 2) located on the front face of the jack.

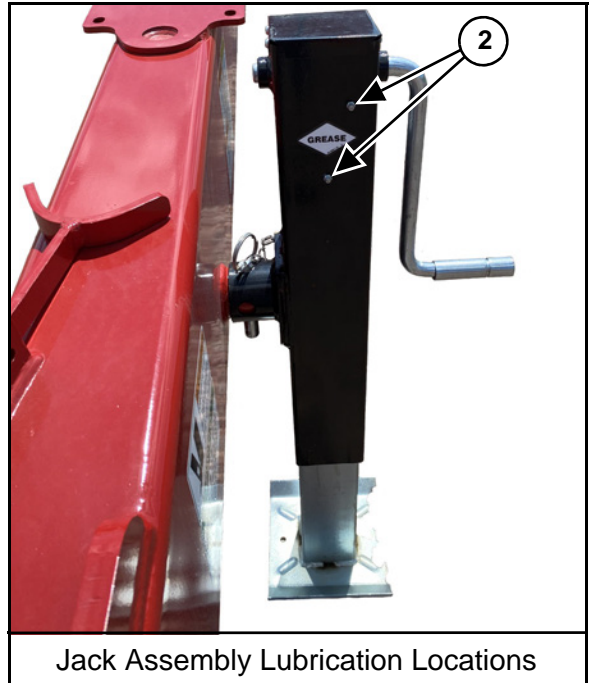



## 8.2 FASTENER TORQUE SPECIFICATIONS



Shutoff and lockout power before adjusting, servicing, maintaining, or clearing an obstruction from this machine. Refer to section 5.3 SHUTOFF & LOCKOUT POWER.



The PB-ADR-B manual should be used in conjunction with this manual.

After an initial break in period approximately four months and periodically thereafter, ALL bolts and nuts should be checked to ensure that recommended torque values are being maintained.

See the PB-ADR-B manual recommendations to properly torque axle and hydraulic suspension components.

### 8.2.1 General Torque Specifications



DO NOT use these values if a different torque value or tightening procedure is given for a specific application. Torque values listed are for general use only and include a + or - 10% variance. Check tightness of fasteners periodically. DO NOT use air powered wrenches.

Shear bolts are designed to fail under predetermined loads. Always replace shear bolts with identical grade.

Head Marking	Grade and Material	Nominal Size Range (inches)
 No Markings	<b>Grade 2</b> Low or medium carbon steel	1/4" thru 3/4" Over 3/4" thru 1-1/2"
 3 Radial Lines	<b>Grade 5</b> Medium carbon steel, quenched and tempered	1/4" thru 1" Over 1" thru 1-1/2"
 6 Radial Lines	<b>Grade 8</b> Medium carbon alloy steel, quenched and tempered	1/4" thru 1-1/2"
 A325	<b>Grade A325</b> Carbon or Alloy Steel with or without Boron	1/2" thru 1-1/2"
Stainless markings vary. Most stainless is non-magnetic	<b>18-8 Stainless</b> Steel alloy with 17-19% Chromium and 8-13% Nickel	All Sizes thru 1"

Figure 8.1 SAE BOLT GRADE

Head Marking	Class and Material	Nominal Size Range (mm)
 8.8	<b>Class 8.8</b> Medium carbon steel, quenched and tempered	All Sizes below 16mm 16mm - 72mm
 10.9	<b>Class 10.9</b> Alloy steel, quenched and tempered	5mm - 100mm
 12.9	<b>Class 12.9</b> Alloy steel, quenched and tempered	1.6mm - 100mm
Stainless markings vary. Most stainless is non-magnetic. Usually stamped A-2.	<b>A-2 Stainless</b> Steel alloy with 17- 19% chromium and 8-13% nickel	All Sizes thru 20mm

Figure 8.2 METRIC BOLT GRADE

<b>SAE</b>				
	<b>Grade 5, 5.1 &amp; 5.2</b>		<b>Grade 8 &amp; 8.2</b>	
<b>Size (inches)</b>	<b>Lubricated (lb-ft)</b>	<b>Dry (lb-ft)</b>	<b>Lubricated (lb-ft)</b>	<b>Dry (lb-ft)</b>
<b>1/4</b>	7	9	10	12.5
<b>5/16</b>	15	18	21	26
<b>3/8</b>	26	33	36	46
<b>7/16</b>	41	52	58	75
<b>1/2</b>	63	80	90	115
<b>9/16</b>	90	115	130	160
<b>5/8</b>	125	160	160	225
<b>3/4</b>	225	280	310	400
<b>7/8</b>	360	450	500	650
<b>1</b>	540	675	750	975
<b>1-1/8</b>	675	850	1075	1350
<b>1-1/4</b>	950	1200	1500	1950
<b>1-3/8</b>	1250	1550	2000	2550
<b>1-1/2</b>	1650	2100	2650	3350

<b>METRIC</b>								
	<b>Class 4.8</b>		<b>Class 8.8 &amp; 9.8</b>		<b>Class 10.9</b>		<b>Class 12.9</b>	
<b>Size (mm)</b>	<b>Lubricated (lb-ft)</b>	<b>Dry (lb-ft)</b>	<b>Lubricated (lb-ft)</b>	<b>Dry (lb-ft)</b>	<b>Lubricated (lb-ft)</b>	<b>Dry (lb-ft)</b>	<b>Lubricated (lb-ft)</b>	<b>Dry (lb-ft)</b>
<b>M6</b>	3.5	4.5	6.5	8.5	9.5	12	11.5	14.5
<b>M8</b>	8.5	11	16	20	24	30	28	35
<b>M10</b>	17	21	32	40	47	60	55	70
<b>M12</b>	29	37	55	70	80	105	95	120
<b>M14</b>	47	60	88	110	130	165	150	109
<b>M16</b>	73	92	140	175	200	225	240	300
<b>M18</b>	100	125	195	250	275	350	325	410
<b>M20</b>	140	180	275	350	400	500	460	580
<b>M22</b>	190	250	375	475	540	675	625	800
<b>M24</b>	250	310	475	600	675	850	800	1000
<b>M27</b>	360	450	700	875	1000	1250	1150	1500
<b>M30</b>	490	625	950	1200	1350	1700	1600	2000
<b>M33</b>	675	850	1300	1650	1850	2350	2150	2750
<b>M36</b>	850	1075	1650	2100	2350	3000	2750	3500

## 8.2.2 Wheel Torque Requirements

BOLT/STUD SIZE	SOCKET SIZE	PRESS FORMED WHEEL CENTER	BOLT TYPE	HEAVY DUTY WHEEL CENTER
22MM	32MM	N/A	Flange Nut	450 lb-ft

## 8.3 TIRES



**Shutoff and lockout power before adjusting, servicing, maintaining, or clearing an obstruction from this machine. Refer to section 5.3 SHUTOFF & LOCKOUT POWER.**

Inflation pressures should be checked at least every week. Recommended inflation pressures based on total load on tires should be used. Always use sealing valve caps to prevent loss of air.

### 8.3.1 Tire Inflation

If tires are to operate for any length of time on roads or other hard surfaces and the draft load is not great, it is advisable to increase the pressure in the tire to the maximum recommendation in order to reduce the movement of the tread bars that causes excessive wiping action.

TIRE SIZE	PSI
710/50R x 26.5	58
800/45R x 26.5	58

## 8.4 BRAKES



**Any corrosive materials (saltwater, fertilizers) are destructive to metals. To properly maintain the life of the brake system flushing with a high pressure water hose is recommended. After washing be sure to grease actuator bearings (slides) and oil all moving parts. At the end of season it is recommended that the brake drums be removed and cleaned inside. Flush wheel bearings being careful not to contaminate the brake system with lube. Readjust the brakes.**



**Before using any equipment equipped with brakes the operation of the brakes should be checked. Brake linings should be replaced before the rivets or support plates come in contact with the wheel drum. Perform all necessary maintenance before using equipment.**

**The PB-ADR-B manual should be used in conjunction with this manual.**

Check and test the brakes before intensive use and every three months thereafter. Check the brake wear and the clearance between the brake linings and the drum visually. It is probable that the linings are worn when the brake travel has increased significantly. If the linings are worn to the minimum thickness, replace with new.

Check that the brakes are clean and clean them if necessary. Lubricate the brake camshaft bearings with grease zerks. To prevent grease from getting on the brake drum or linings, do not over grease.

## 8.5 STORING THE IMPLEMENT

Sometimes it may be necessary to store your Meyer trailer for an extended period of time. Below is a list of items to perform before storage.

- Fully empty the trailer.
- Thoroughly clean the equipment.
- Lubricate the equipment. (See 8.1 LUBRICATION on page 33.)
- Make appropriate adjustments to equipment.
- Inspect the hitch and all welds on the equipment for wear and damage.
- Check for loose hardware, missing guards, or damaged parts.
- Check for damaged or missing safety signs (decals). Replace if necessary.
- Replace worn or damaged parts.
- Touch up all paint nicks and scratches to prevent rusting.
- Place the equipment in a dry protected shelter.
- Place the equipment flat on the ground.

## **8.6 RETURN THE IMPLEMENT TO SERVICE**

After the Meyer trailer has been in storage, it is necessary to follow a list of items to return the equipment to service.

- Be sure all shields and guards are in place.
- Lubricate the equipment. (See 8.1 LUBRICATION on page 33.)
- Connect to a tractor and operate equipment, verify all functions operate correctly.
- Check for leaks. Repair as needed.



## 9.0 REPAIR PARTS

### **WARNING**

Before servicing this equipment, ensure that all personnel, including family members are familiar with the equipment and the safety hazards that are present, along with the safety practices that should be observed while working in this equipment.

### **CAUTION**

Inspect the axles, o-beams, spindles, tires, hitches and all safety shielding, safety signs and safety lighting regularly. These parts if not watched closely, could pose potential injury or death. If any part is found in need of repair, follow the SHUTOFF & LOCKOUT POWER recommendations and have qualified personnel repair immediately.

### **CAUTION**

Shutoff and lockout power before adjusting, servicing, maintaining, or clearing an obstruction from this machine. Refer to section 5.3 SHUTOFF & LOCKOUT POWER.

### **IMPORTANT**

It is important that everyone who works on this equipment is properly trained to help ensure that they are familiar with this procedure and that they follow the steps outlined above. This manual will remind you when to SHUTOFF & LOCKOUT POWER.

At times, parts on this implement will become worn or damaged. Performing repairs on this implement can pose a risk of injury including death. To reduce risk, the party that will be doing the repair should be very knowledgeable of the implement and the equipment that they will be using to do the repair.

- Review the repair so that a plan can be put together and the proper equipment can be used to repair this implement safely and correctly.
- Personal safety equipment may include items such as safety glasses, protective footwear, hearing protection, gloves, fire retardant clothes, etc.

### **WARNING**

**Crushing Hazard:**  
Do Not work under suspended or blocked parts



- The use of hoists and/or supports may be needed to handle heavy components.
- If the implement is being repaired in the field, make sure the parking brake of the tractor is engaged, the implement is on solid and level ground.
- Welding and torching should be done by properly trained individuals who have proven their skills.

### **IMPORTANT**

Call the factory for any additional details you may need to perform the repair. Some parts may come with instruction sheets to assist in the repair. Instruction sheets may be provided with the parts order. Otherwise, if available, instruction sheets can be e-mailed or faxed for your convenience. Call Meyer Manufacturing Corporation toll free at 1-800-325-9103 or email [parts@meyermfg.com](mailto:parts@meyermfg.com).

**NOTE:** Be environmentally friendly and dispose of any waste materials properly. Recycle when appropriate.

# HSTS30 TRAILER ASSEMBLY

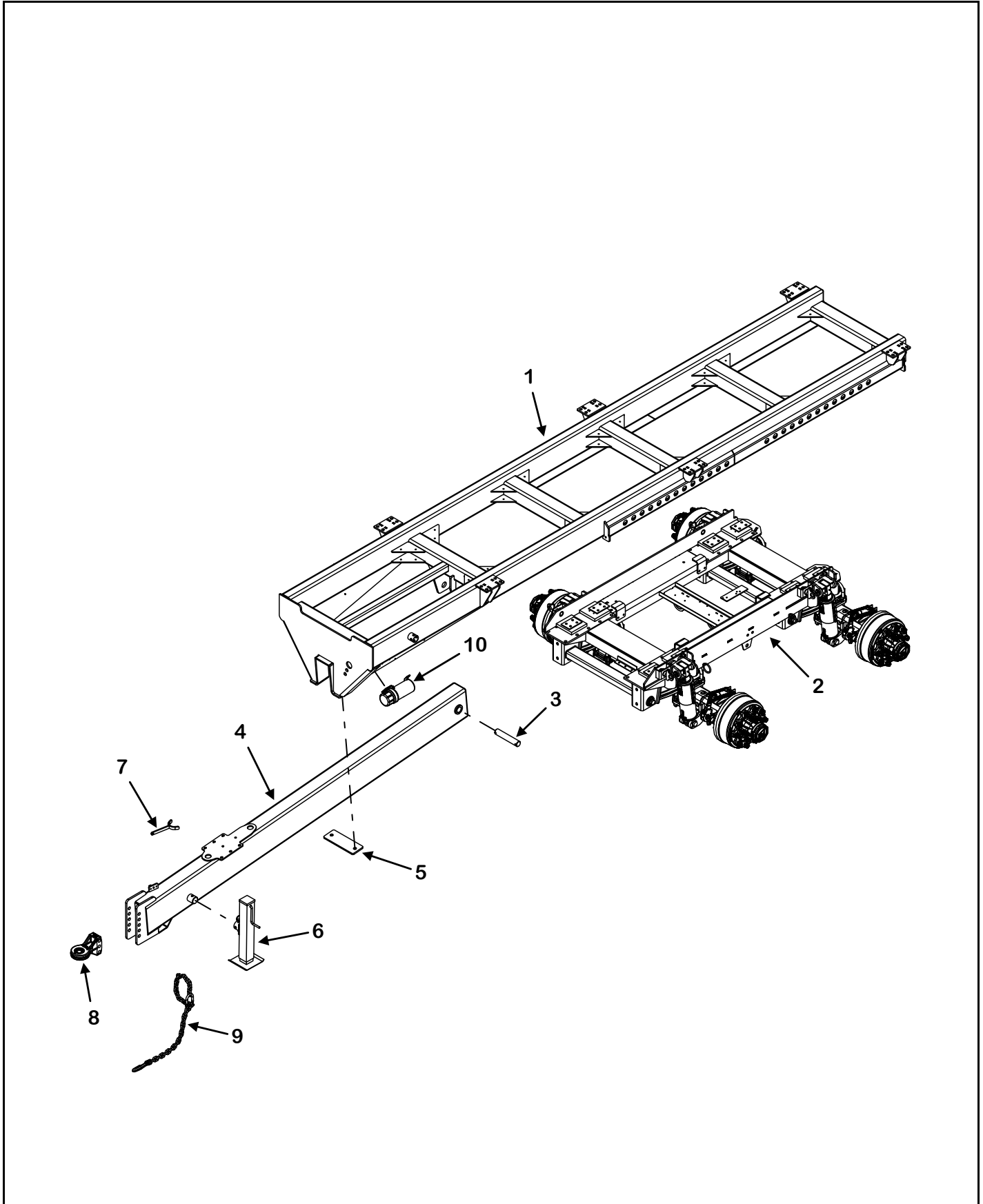

<b>KEY</b>	<b>PART NUMBER</b>	<b>QTY</b>	<b>DESCRIPTION</b>
1	675-1000	1	Trailer Weldment
2	See Page 44	1	Complete Slider Frame Assembly
3	675-1002-7	1	Tongue Pin
4	675-1002	1	Trailer Tongue Weldment
5	675-1014	1	Hitch Tube Keeper Plate Weldment
6	956-3804	1	10,000# Square Jack Less Mount Tube
7	925-3775-1	1	PTO Support Cradle Weldment
8	75-2028-KIT	1	Cast Swivel Hitch Assembly 1-1/2" & 2" Inserts
	75-2028-2	1	1-1/2" Pin Bushing Insert
	75-2028-3	1	Snap Ring
	75-2028-1	1	Ball, Swivel
9	52-0052	1	Safety Chain, 60,000# Capacity
10	33-0060	1	Manual Canister

# HSTS30 SLIDER FRAME ASSEMBLY

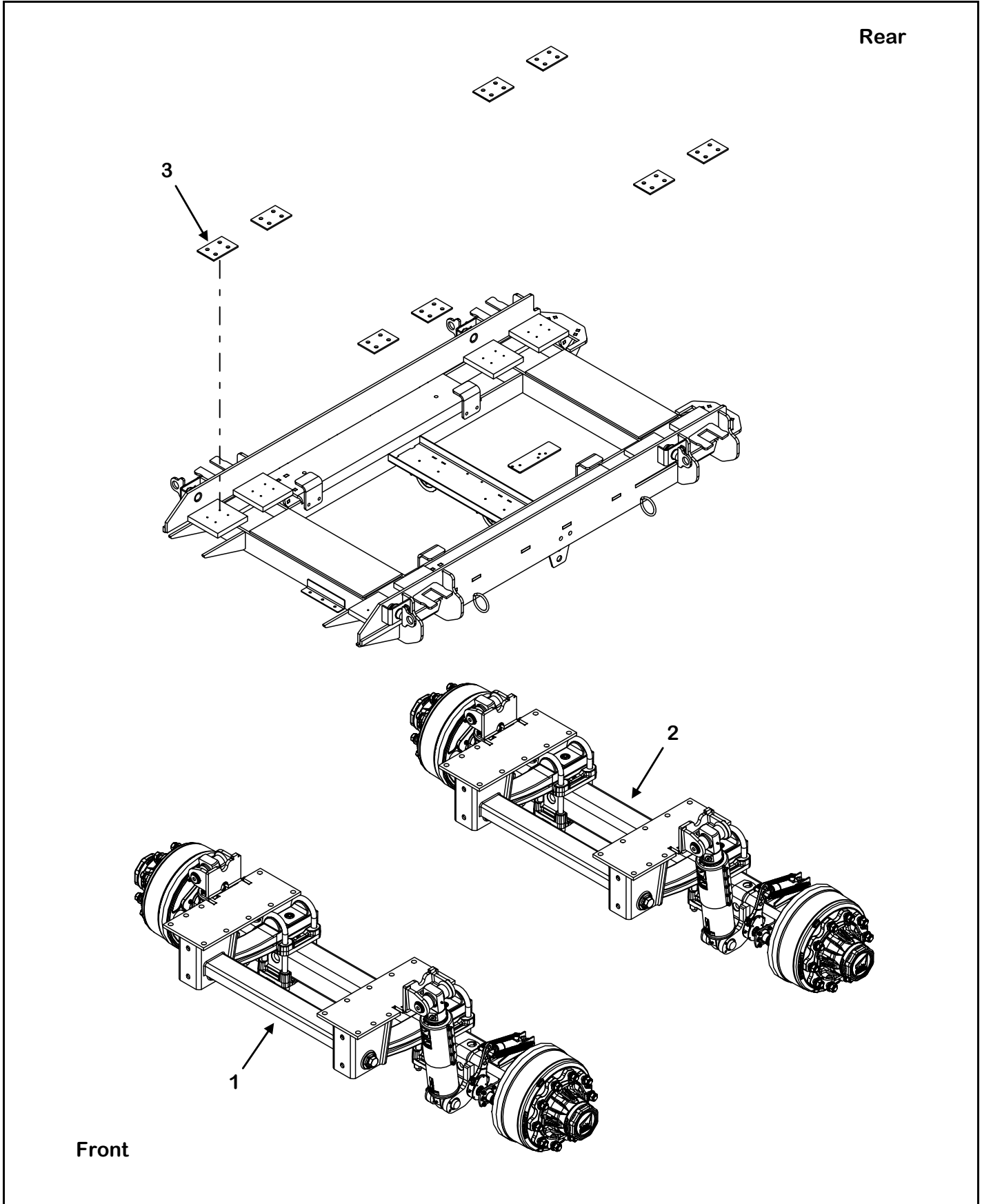

<b>KEY</b>	<b>PART NUMBER</b>	<b>QTY</b>	<b>DESCRIPTION</b>
0	675-1001	1	Slider Axle Assembly
1	675-0001	1	Rigid Axle With Hubs
	See Page 56	1	Rigid Axle
	See Page 60	1	Hydraulic Suspension
2	675-0002	1	Steerable Axle With Hubs (RS Model)
	See Page 58	1	Steerable Axle (RS Model)
	675-0001	1	Rigid Axle With Hubs (RR Model)
	See Page 56	1	Rigid Axle (RR Model)
	See Page 60	1	Hydraulic Suspension
3	75-2433-1-4	8	Slider Pad

# HSTS30 HYDRAULIC LIFT FRONT HOSES

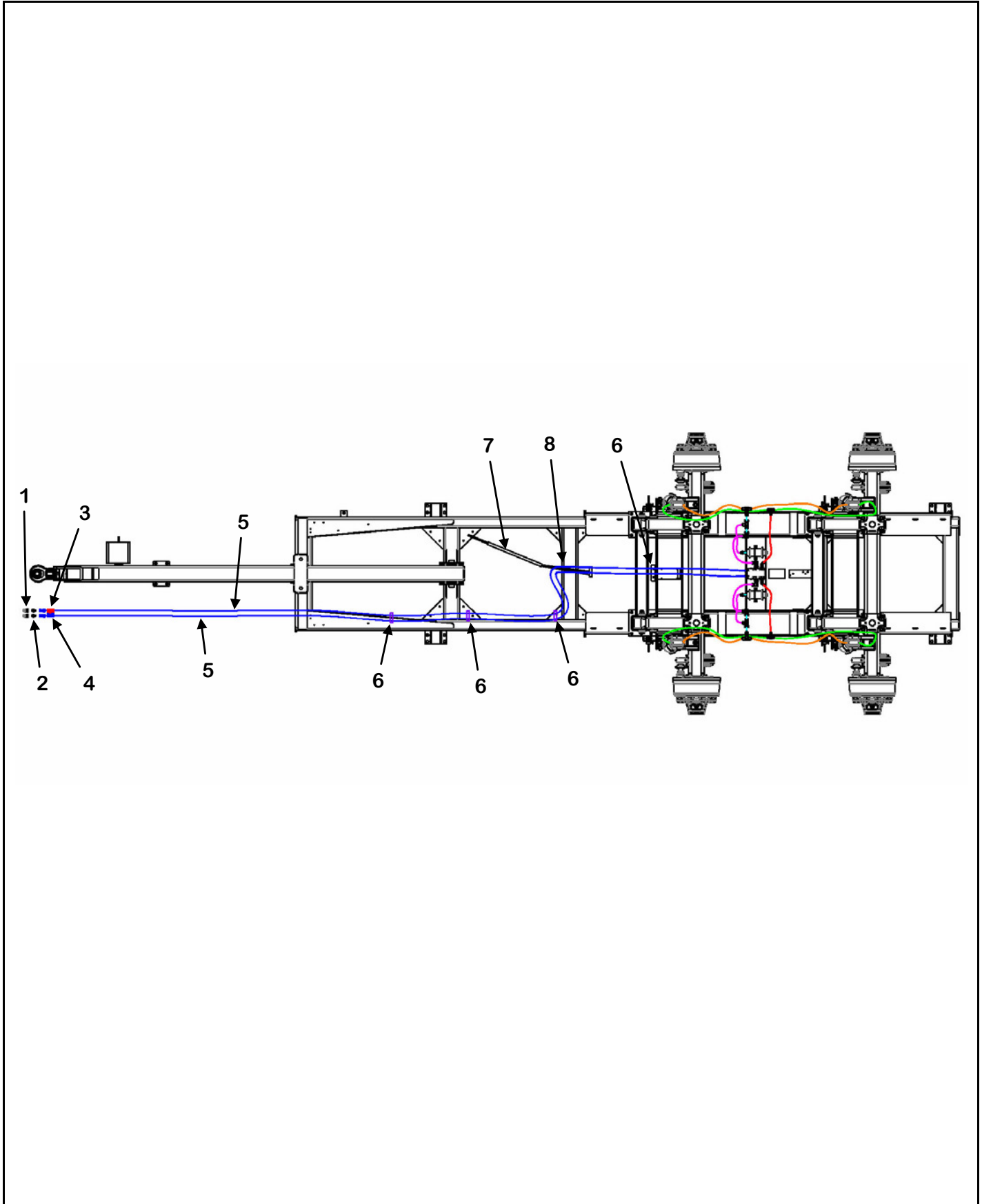

<b>KEY</b>	<b>PART NUMBER</b>	<b>QTY</b>	<b>DESCRIPTION</b>
1	155-8010-15	2	ORB Male Tip
2	155-6400-6-8	2	Straight Adapter
3	32-0053	6	Red Cable Tie
4	32-0054	6	Blue Cable Tie
5	155-04R17-354-1	2	1/4" x 354" Hose Assembly
6	55-0324	20	Compact Twin Series Clamp
	851-3816-3.25Z	5	3/8"-16 x 3-1/4" Cap Screw
	815-3816-Z	7	3/8"-16 Nylon Insert Lock Nut
	805-0038-Z	5	3/8" Flat Washer
7	29-0029	1	25" Hydraulic Hose Tender Spring Kit With Sleeve & Hardware
8	933-3804	1	5/16"-18 x 3-3/4" Shank Eye Bolt
	810-3118-Z	1	5/16"-18 Spin Lock Nut
	815-3118-Z	1	5/16"-18 Nylon Insert Lock Nut
	805-0031-Z	1	5/16" Flat Washer

# HSTS30 HYDRAULIC LIFT

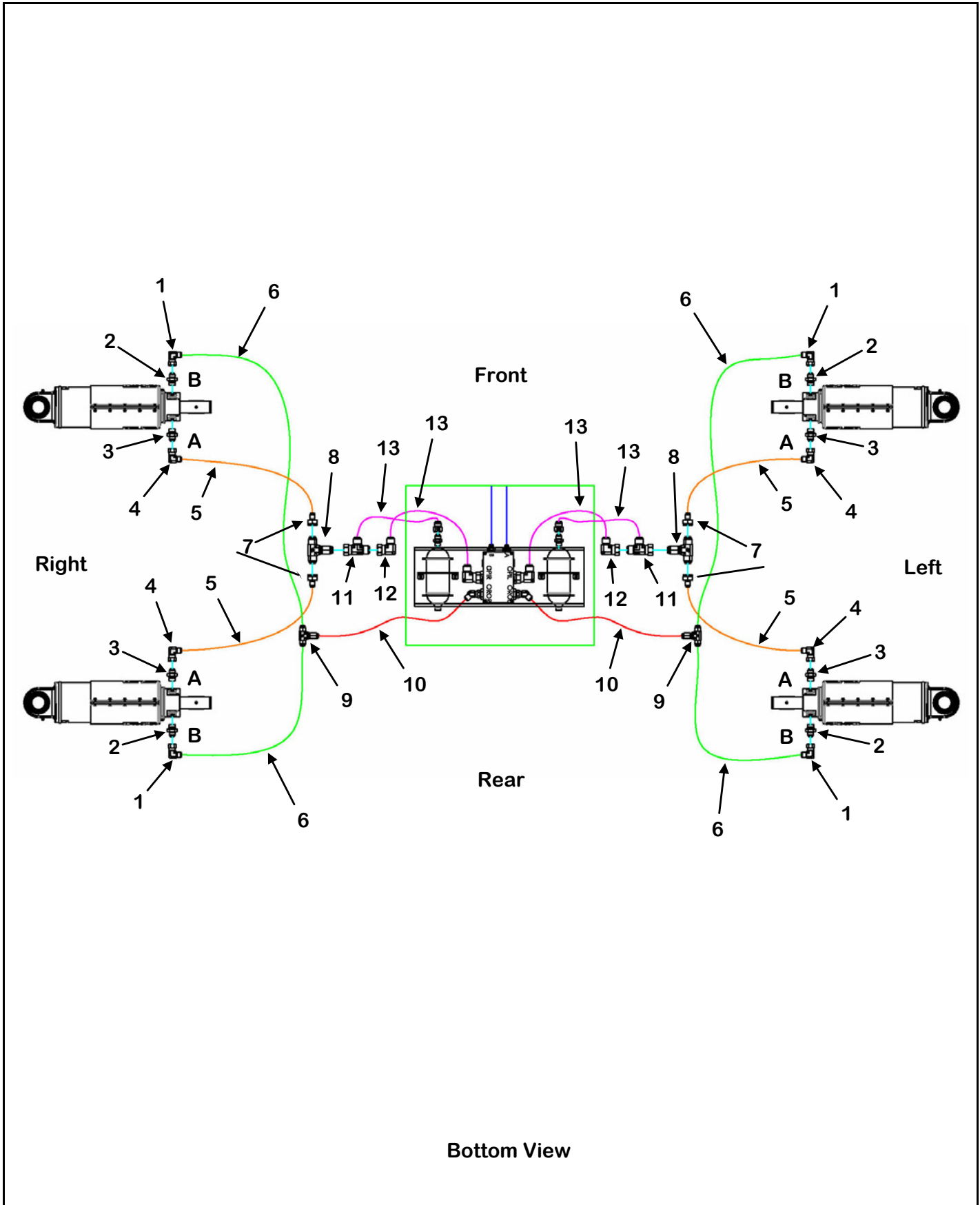



KEY	PART NUMBER	QTY	DESCRIPTION
1	155-6500-08-08	4	90° Elbow
2	155-9002-8-8	4	Straight Adapter
3	155-7002-12-08	4	Straight Adapter (HSTS30-RR)
	155-9002-8-8	4	Straight Adapter (HSTS30-RS)
4	155-6500-12	4	90° Elbow (HSTS30-RR)
	155-6500-08-08	4	90° Elbow (HSTS30-RS)
5	155-12R17-38-1	4	3/4" x 38" Hose Assembly (HSTS30-RR)
	155-08R17-37-1	4	1/2" x 37" Hose Assembly (HSTS30-RS)
6	155-08R17-50-1	4	1/2" x 50" Hose Assembly
7	155-2406-12-08	4	Straight Adapter (HSTS30-RS Only)
8	155-2703-12-12-12	2	Tee
9	155-2703-08-08-08	2	Tee
10	155-08R17-20-1	2	1/2" x 20" Hose Assembly
11	155-6602-12A	2	Tee
12	155-6500-12	2	90° Elbow
13	155-12R16-30-1	4	3/4" x 30" Hose Assembly

# HSTS30 HYDRAULIC LIFT MANIFOLD

Manifold Top View

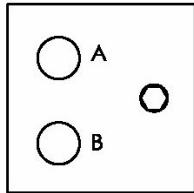

Detail A

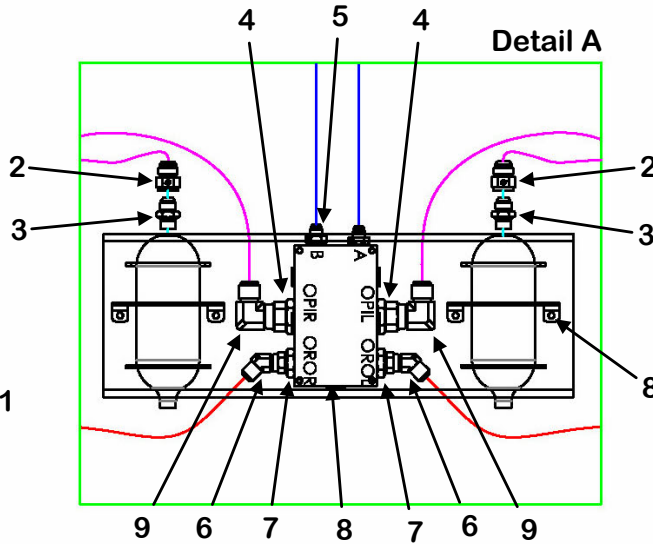

Manifold Left View

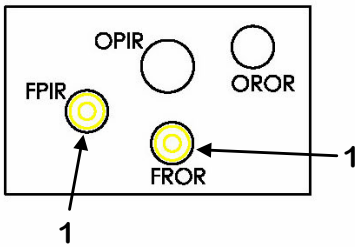

Manifold Right View

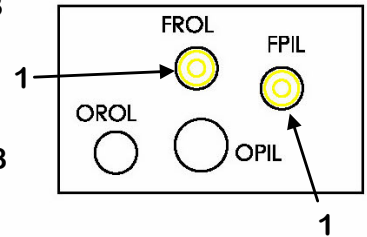

Manifold Bottom View

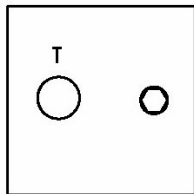

<b>KEY</b>	<b>PART NUMBER</b>	<b>QTY</b>	<b>DESCRIPTION</b>
1	155-9522-H08	4	Plug
2	155-2406-08-12	2	Straight Adapter
3	155-7005-08-18	2	Straight Adapter
4	155-7002-12-12	2	Straight Adapter
5	155-JB06-06	2	Straight Adapter
6	155-6502-08-08	2	45° Elbow
7	155-9002-8-8	2	Straight Adapter
8	675-0003-1	1	Manifold (Prior To 2023 Model Year)
	675-0004-2	1	Manifold (2023 Model Year & Later)
	831-2520-4.25Z	4	1/4"-20 x 4-1/4" Hex Cap Screw
	815-2520-Z	4	1/4"-20 Nylon Insert Lock Nut
9	155-6500-12	2	90° Elbow

# HSTS45 TRAILER ASSEMBLY

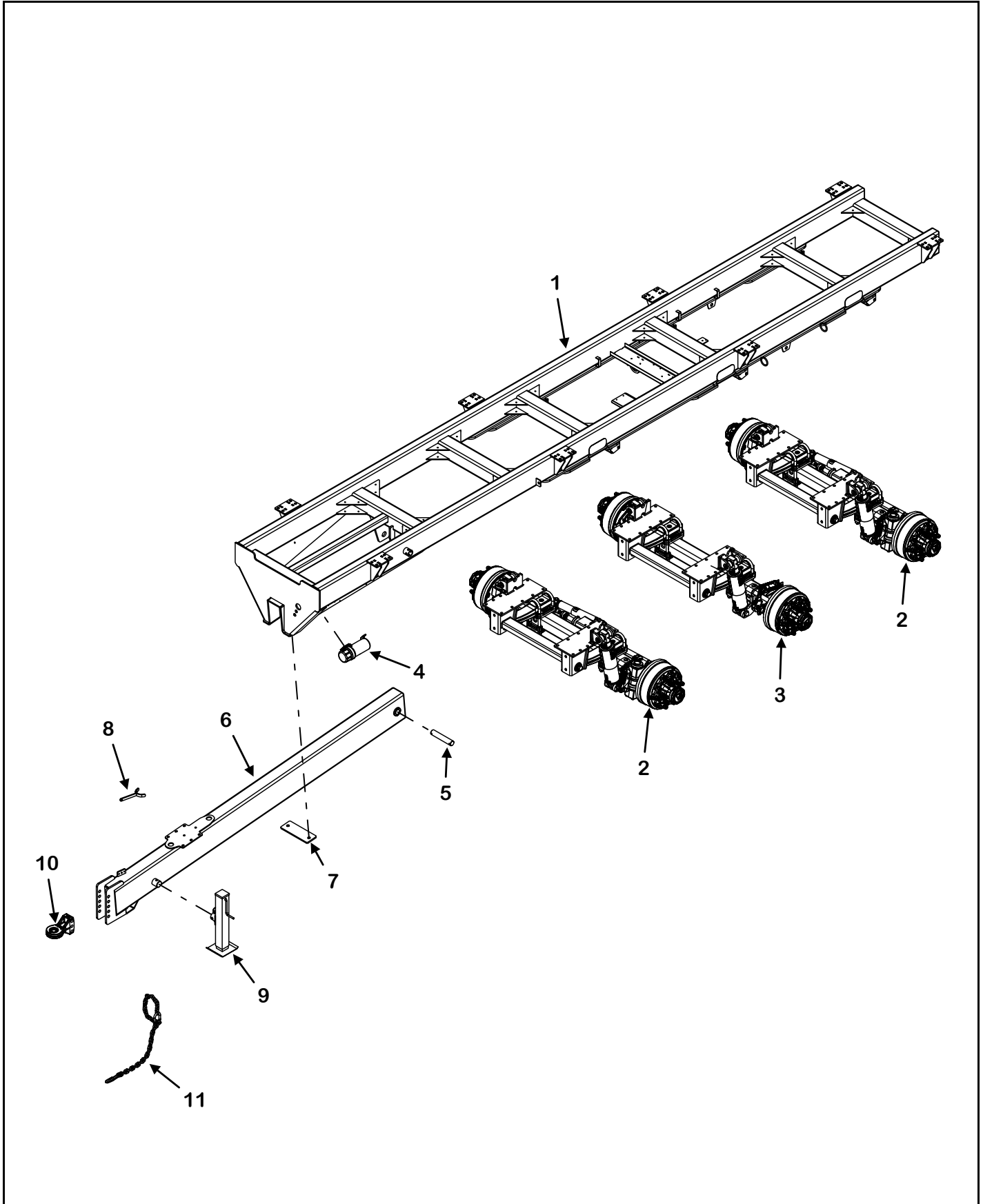

<b>KEY</b>	<b>PART NUMBER</b>	<b>QTY</b>	<b>DESCRIPTION</b>
1	675-1005	1	Trailer Weldment
2	675-0002	2	Steerable Axle With Hubs
	See Page 58	2	Steerable Axle
	See Page 60	2	Hydraulic Suspension
3	675-0001	1	Rigid Axle With Hubs
	See Page 56	1	Rigid Axle
	See Page 60	1	Hydraulic Suspension
4	33-0060	1	Manual Canister
5	675-1002-7	1	Tongue Pin
6	675-1002	1	Trailer Tongue Weldment
7	675-1002-6	1	Hitch Tube Keeper Plate
8	925-3775-1	1	PTO Support Cradle Weldment
9	956-3804	1	10,000# Square Jack Less Mount Tube
10	75-2028-KIT	1	Cast Swivel Hitch Assembly 1-1/2" & 2" Inserts
	75-2028-2	1	1-1/2" Pin Bushing Insert
	75-2028-3	1	Snap Ring
	75-2028-1	1	Ball, Swivel
11	52-0055	1	Safety Chain, 80,000# Capacity

# HSTS45 HYDRAULIC LIFT

Front

A - Pressure  
B - Return

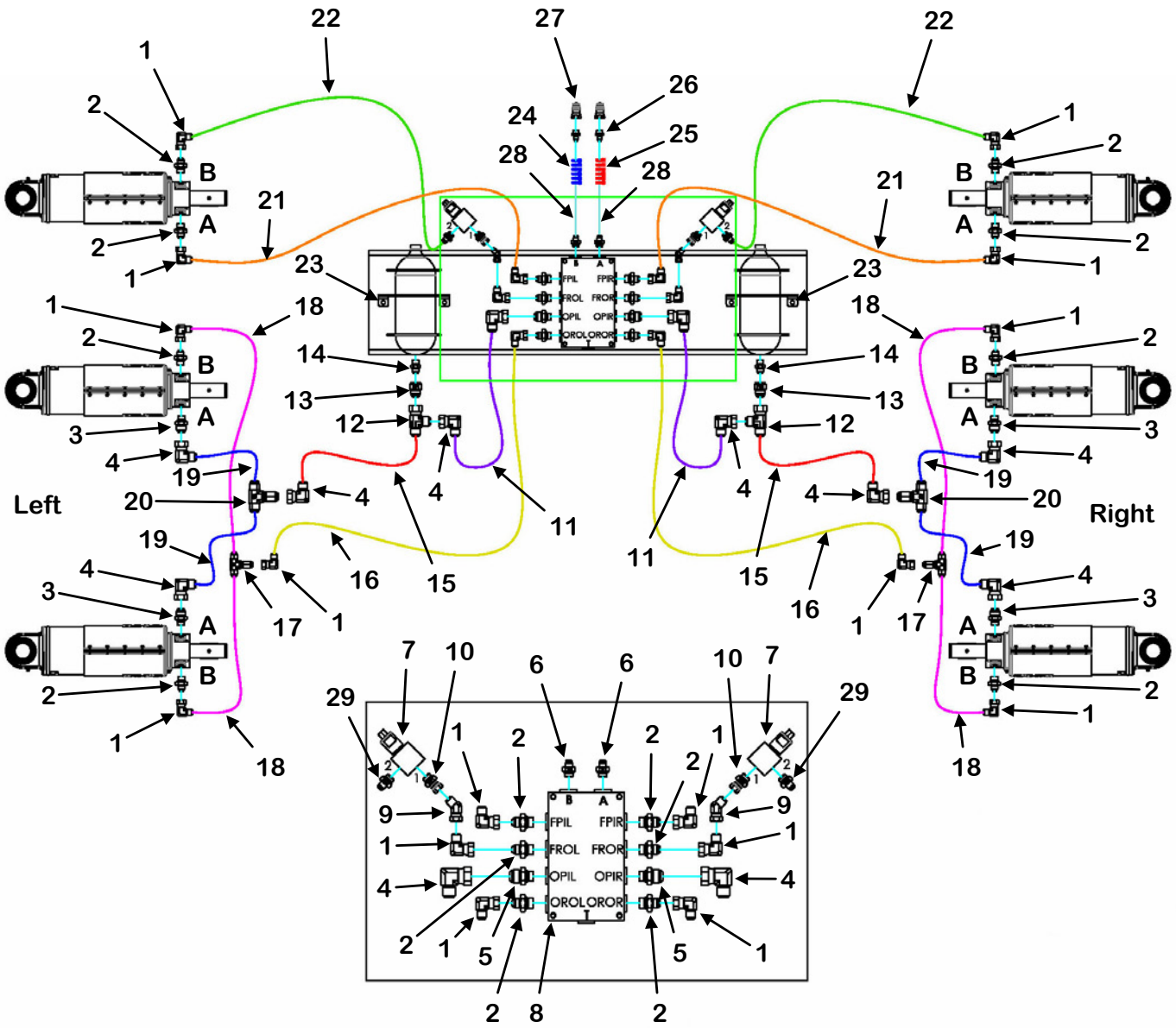

Rear

KEY	PART NUMBER	QTY	DESCRIPTION
1	155-6500-08-08	16	90° Elbow
2	155-9002-8-8	14	Straight Adapter
3	155-7002-12-08	4	Straight Adapter
4	155-6500-12	10	90° Elbow
5	155-7002-12-12	2	Straight Adapter
6	155-JB06-06	2	Straight Adapter
7	155-NCPV-10-V	2	2-Stage Valve Assembly
8	675-0003-1	1	Manifold
	831-2520-4.5Z	4	1/4"-20 x 4-1/2" Hex Cap Screw
	815-2520-Z	4	1/4"-20 Nylon Insert Lock Nut
9		2	
10		2	
11	155-12R16-30-1	2	3/4" x 30" Hose Assembly
12	155-6602-12A	2	Tee
13	155-2406-08-12	2	Straight Adapter
14	155-7005-08-18	2	Straight Adapter
15	155-12R17-45-2	2	3/4" x 45" Hose Assembly
16	155-08R17-52-1	2	1/2" x 52" Hose Assembly
17	155-2703-08-08-08	2	Tee
18	155-08R17-50-1	4	1/2" x 50" Hose Assembly
19	155-12R17-38-1	4	3/4" x 38" Hose Assembly
20	155-2703-12-12-12	2	Tee
21	155-08R17-59-1	2	1/2" x 59" Hose Assembly
22	155-08R17-70-1	2	1/2" x 70" Hose Assembly
23	851-2520-1Z	4	1/4"-20 x 1" Hex Cap Screw
	810-2520-Z	4	1/4"-20 Spin Lock Nut
	805-0025-Z	4	1/4" Flat Washer
24	32-0054	6	Blue Cable Tie
25	32-0053	6	Red Cable Tie
26	155-6400-6-8	2	Straight Adapter
27	155-8010-15	2	ORB Male Tip
28	155-04R17-367-1	2	1/4" x 367" Hose Assembly
29	155-6400-8-8	2	Straight Adapter

# RIGID AXLE

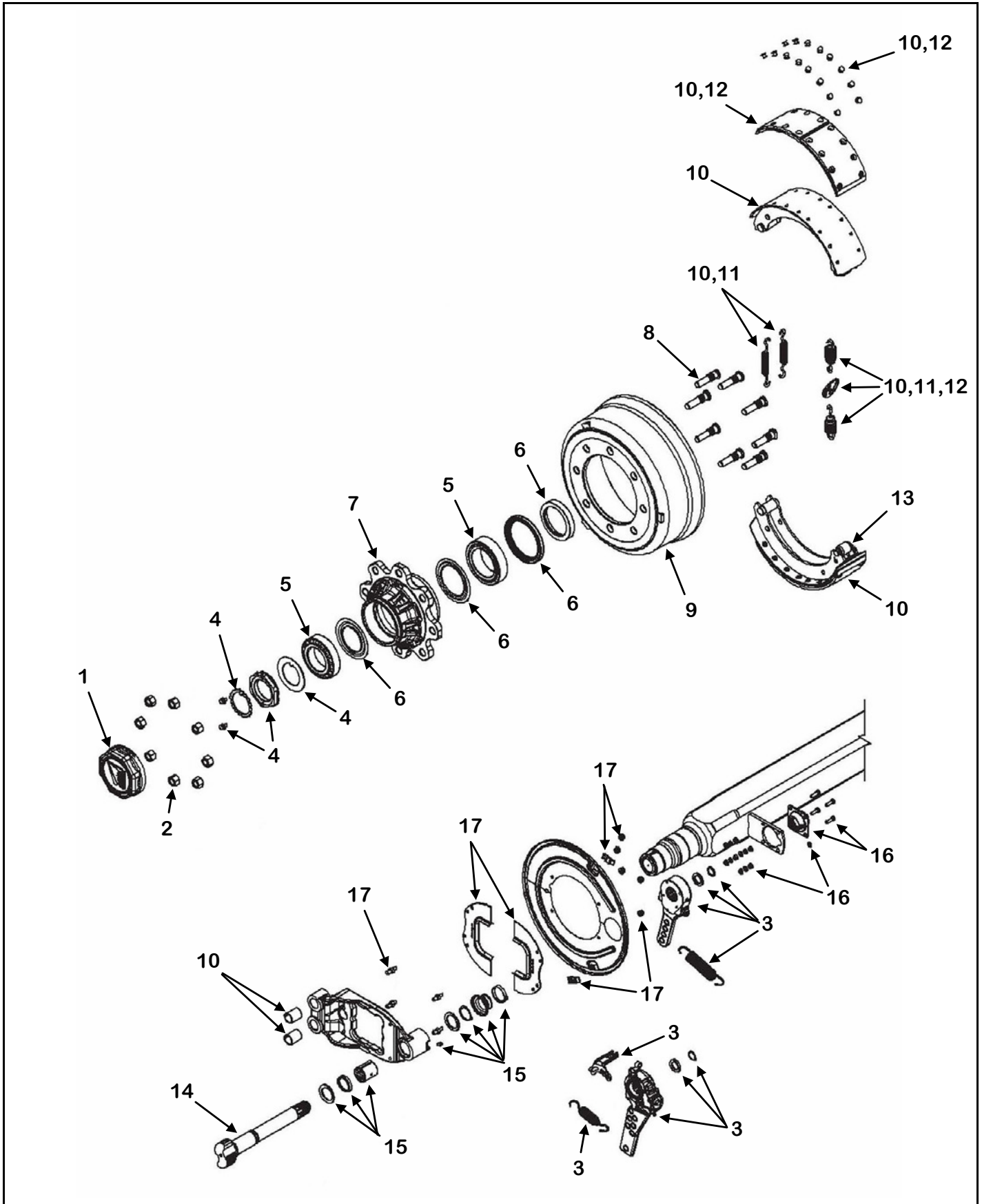



KEY	PART NUMBER	QTY	DESCRIPTION
1	675-0002-5	2	Cap Kit
2	75-4500-1-1-2-1	AR	Lug Nut
3	75-4515-1-3	1	Left Slack Adjuster
	75-4515-1-4	1	Right Slack Adjuster
4	675-0002-6	2	Spindle Nut Kit
5	675-0002-7	2	Wheel Bearing Kit
6	675-0002-8	2	Race & Seal Kit
7	675-0002-9	2	Hub Casting
8	75-4500-1-1-1	2	Wheel Stud Kit (10 Wheel Studs Per Kit)
	75-4500-1-1-1-1	16	Wheel Stud
9	675-0001-8	2	Drum
10	675-0001-9	2	Brake Shoe Kit Contains Brake Shoes, Springs, Extender & Bushing
11	75-4505-1-3-K	2	Spring Kit Contains Brake Springs, Shoe Springs & Extender
12	675-0001-10	2	Lining Kit
13	675-0001-11	1	Roll Brake Kit
14	675-0001-12	1	Right Cam Shaft
	675-0001-13	1	Left Cam Shaft
15	75-4505-1-CAM-K	1	Camshaft Kit (Does Not Include Cams)
	75-4505-1-6	4	Washer
	75-4505-1-7	4	Grease Seal
	75-4505-1-8	2	Bushing
	75-4500-1-3-21	2	Snap Ring
	75-4505-1-14	2	Rubber Cap
	75-4505-1-17	2	Grease Zerk
16	675-0001-14	2	Wearing Brake Kit
17	675-0001-15	2	Protection Plate Kit
NS	675-0001-7	1	Washer Close Type Kit

# STEERABLE AXLE

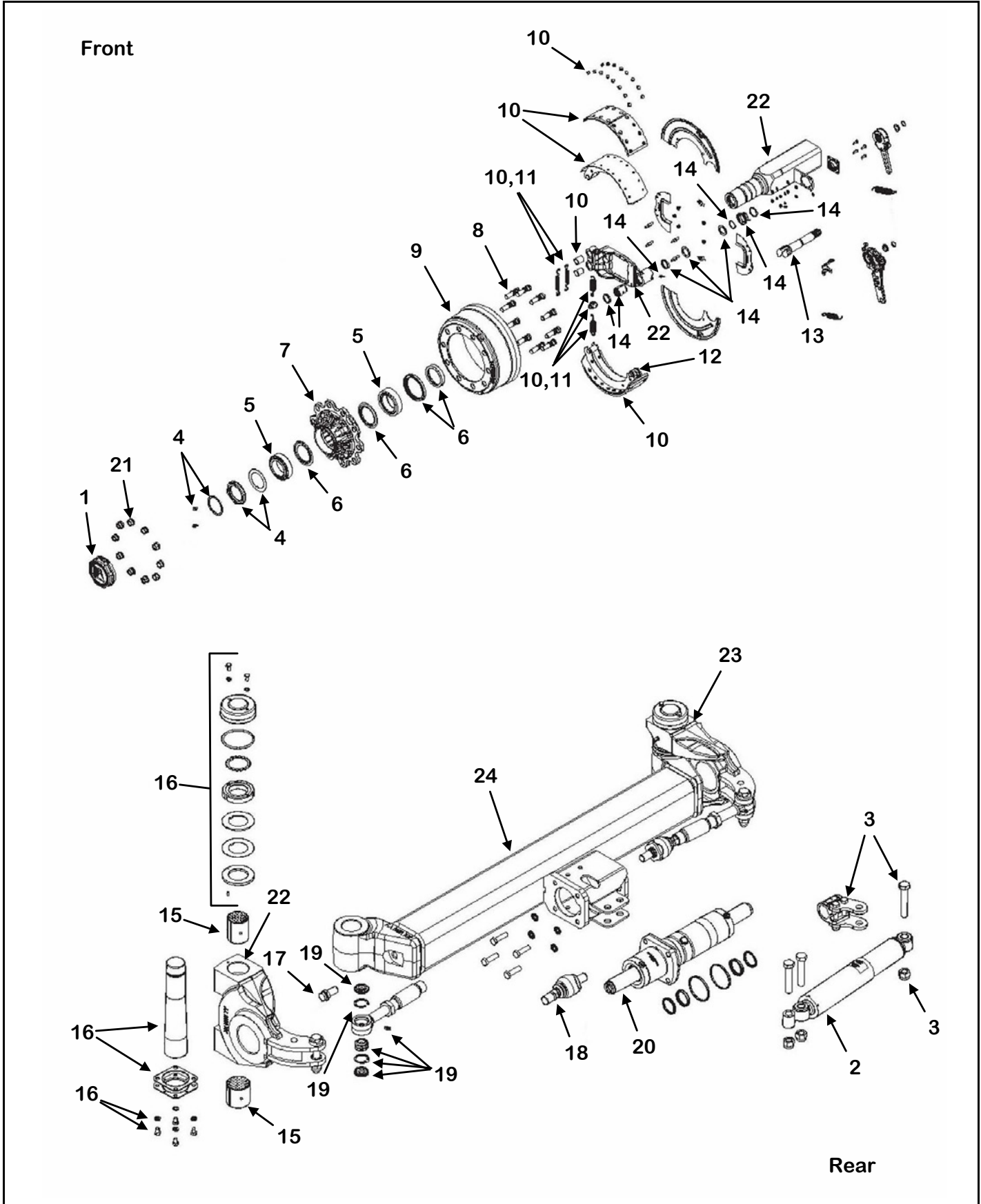

KEY	PART NUMBER	QTY	DESCRIPTION
1	675-0002-5	2	Cap Kit
2	75-4500-1-3-38	1	Shock Absorber
3	675-0002-14	1	Shock Support Kit
4	675-0002-6	2	Spindle Nut Kit
5	675-0002-7	2	Wheel Bearing Kit
6	675-0002-8	2	Race & Seal Kit
7	675-0002-9	2	Hub Casting
8	675-0002-10	2	Wheel Stud Kit
	675-0002-10-1	20	Wheel Stud
9	75-4505-1-1	2	Drum
10	75-4505-1-10-K	2	Brake Shoe Kit With Brake Shoes, Springs, Extenders & Bushing
	75-4505-1-3	4	Brake Spring
	75-4505-1-10	4	Brake Shoe
	75-4505-1-18	4	Brake Shoe Spring
	75-4505-1-19	4	Bushing
	75-4505-1-2	2	Spring Extender
11	75-4505-1-3-K	1	Spring Kit Includes Brake Springs, Shoe Springs & Extenders
	75-4505-1-2	2	Spring Extender
	75-4505-1-3	4	Brake Spring
	75-4505-1-18	4	Brake Shoe Spring
12	675-0001-11	2	Roll Brake Kit
13	675-0002-12	2	Cam Kit
14	75-4505-1-CAM-K	1	Camshaft Kit (Does Not Include Cams)
	75-4505-1-6	4	Washer
	75-4505-1-7	4	Grease Seal
	75-4505-1-8	2	Bushing
	75-4505-1-3-21	2	Snap Ring
	75-4505-1-14	2	Rubber Cap
	75-4505-1-17	2	Grease Zerk
15	675-0002-3-1	2	Bushing Kit
16	675-0002-4	2	Pin & Cap Kit
17	75-4500-1-2-4	1	Stop Kit (Includes 4 Stop Bolts)
18	75-4505-1-38	2	Axial Ball Joint
19	675-0002-13	2	Steering Joint Kit
20	75-4505-1-42	1	Hydraulic Cylinder
21	75-4500-1-1-2-1	AR	Lug Nut
22	675-0002-1	1	Complete Left Hand Wheel End Assembly
	675-0002-1-1	1	Left Hand Spindle Steering Weldment
23	675-0002-2	1	Complete Right Hand Wheel End Assembly
	675-0002-2-1	1	Right Hand Spindle Steering Weldment
24	675-0002-3	1	Axle Weldment Only

# HYDRAULIC SUSPENSION

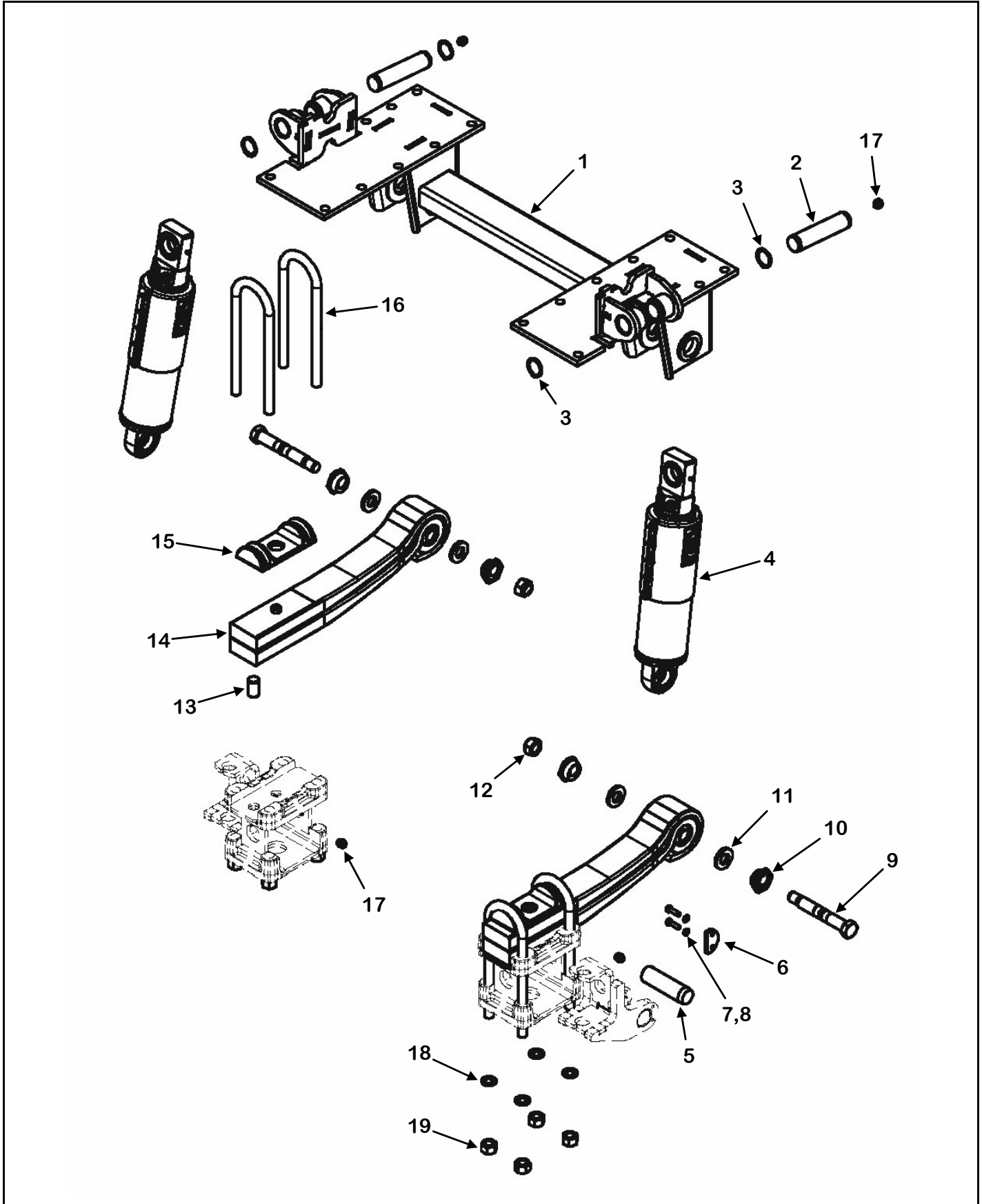

<b>KEY</b>	<b>PART NUMBER</b>	<b>QTY</b>	<b>DESCRIPTION</b>
1	675-0001-5	1	Suspension Mount Bracket
2	675-0002-15	2	Upper Cylinder Mount Pin
3	675-0002-16	4	Snap Ring
4	675-0002-17	2	Hydraulic Cylinder
5	675-0002-18	2	Lower Cylinder Mount Pin
6	675-0002-19	2	Pin Retainer
7	75-4500-1-2-2-5	4	Washer
8	675-0002-20	4	M10 x 1.50 Screw
9	675-0002-21	2	Leaf Spring Pin
10	675-0002-22	4	Eccentric Sleeve
11	675-0002-23	4	Spacer
12	675-0002-24	2	Self-Locking Nut
13	675-0002-25	2	Leaf Spring Alignment Pin
14	675-0002-26	2	Leaf Spring
15	675-0002-27	2	Clamping Wedge
16	675-0002-28	4	U-Bolt
17	675-0002-29	4	Polythene Cap
18	675-0002-30	8	Washer
19	675-0002-31	8	M2 x 2.00 Nut

# HSTS30-RS LOCK & STEER HYDRAULIC SYSTEM

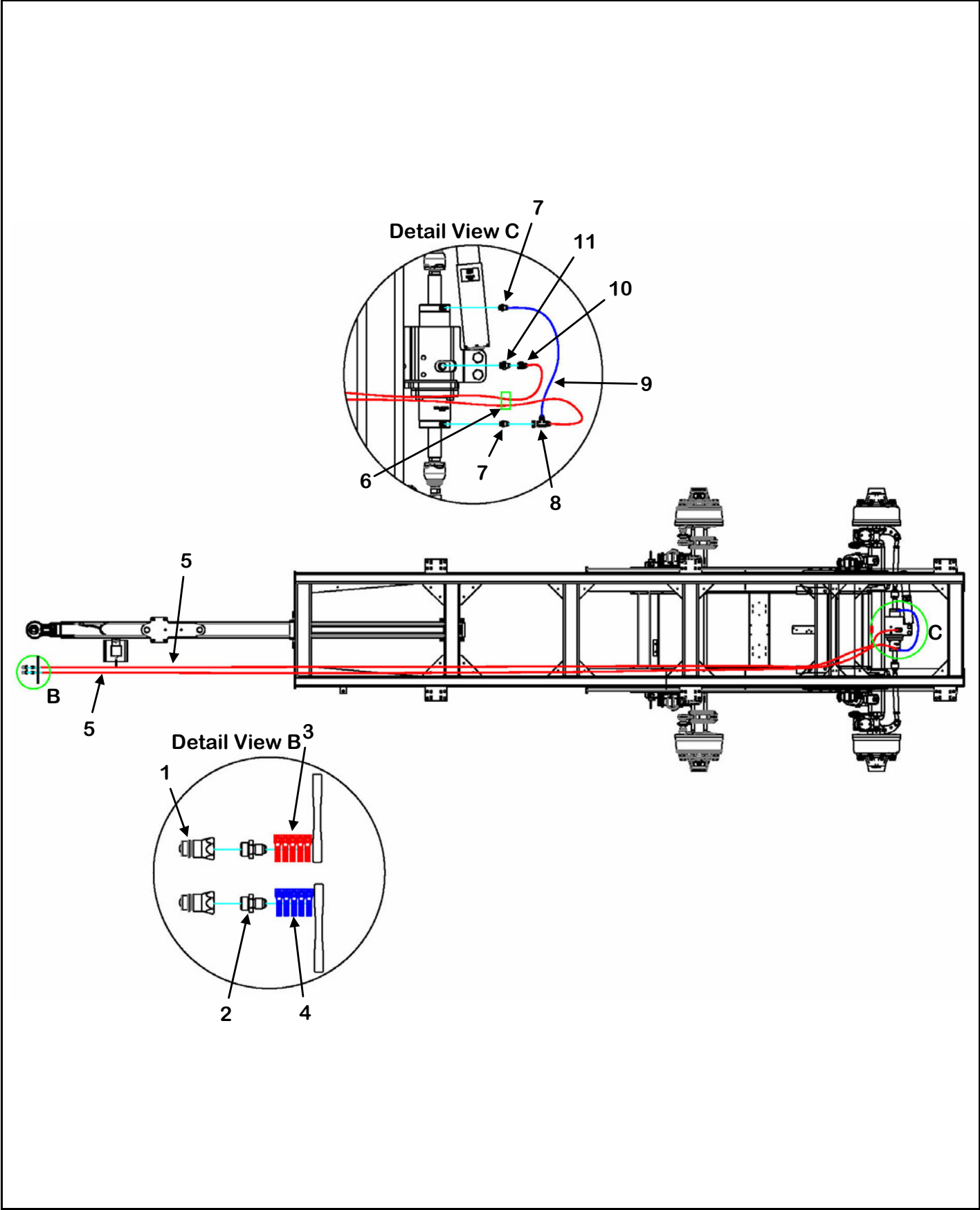

<b>KEY</b>	<b>PART NUMBER</b>	<b>QTY</b>	<b>DESCRIPTION</b>
1	155-8010-15	2	ORB Male Tip
2	155-6400-6-8	2	Straight Adapter
3	32-0053	5	Red Cable Tie
4	32-0054	5	Blue Cable Tie
5	155-04R17-437-1	2	1/4" x 437" Hose Assembly
6	55-0324	2	Compact Twin Series Clamp
	815-3816-Z	1	3/8"-16 Nylon Insert Lock Nut
	851-3816-2.25Z	1	3/8"-16 x 2-1/4" Cap Screw
	805-0038-Z	1	3/8" Flat Washer
7	155-7002-06-04	2	Straight Adapter
8	155-6602-06-06-06	1	Tee
9	155-04R17-15-1	1	1/4" x 15" Hose Assembly
10	155-2406-06-06	1	Straight Adapter
11	155-JB06-06	1	Straight Adapter

# HSTS45-SRS LOCK & STEER HYDRAULIC SYSTEM

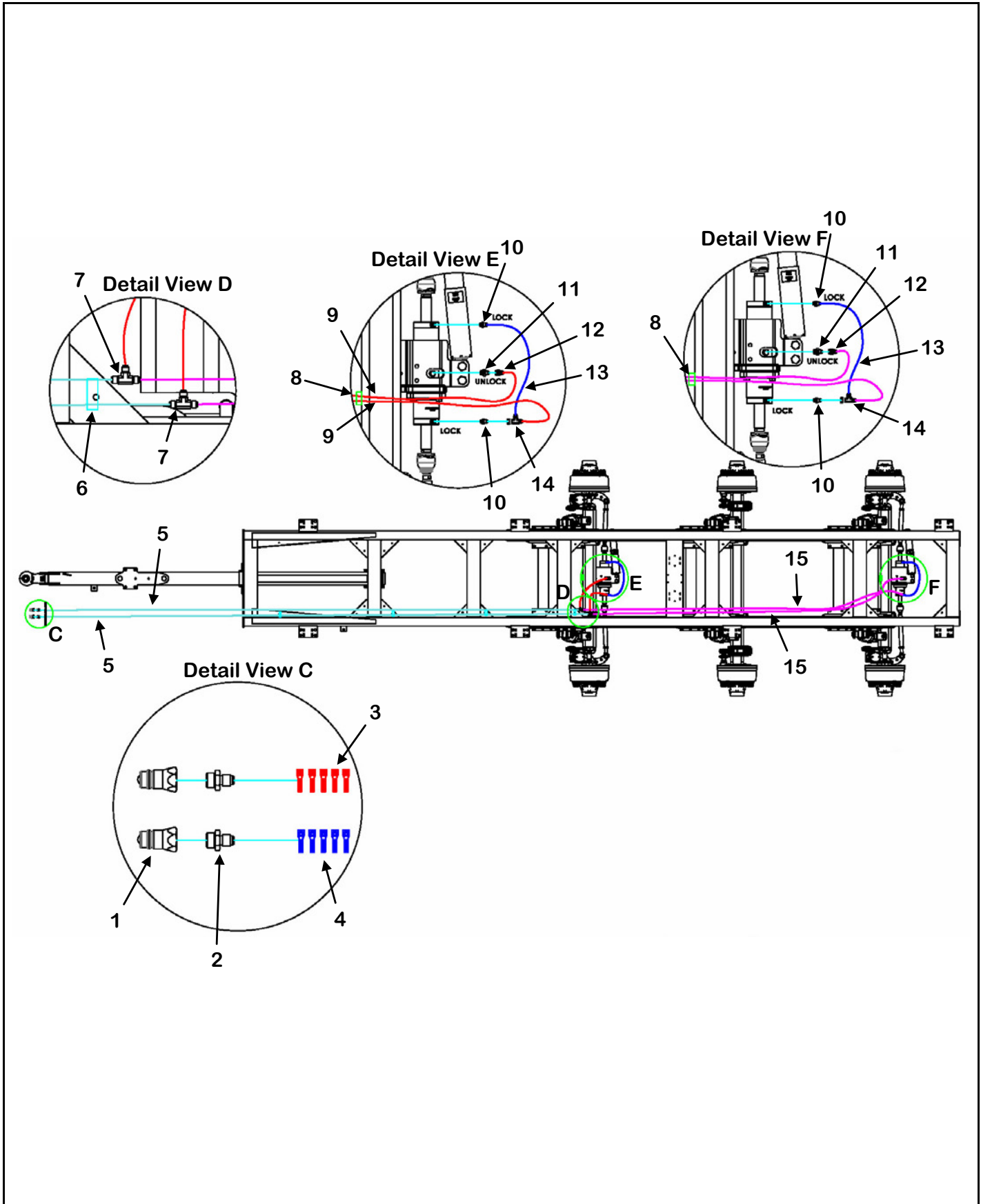



<b>KEY</b>	<b>PART NUMBER</b>	<b>QTY</b>	<b>DESCRIPTION</b>
1	155-8010-15	2	ORB Male Tip
2	155-6400-6-8	2	Straight Adapter
3	32-0053	5	Red Cable Tie
4	32-0054	5	Blue Cable Tie
5	155-04R17-296-1	2	1/4" x 296" Hose Assembly
6	32-0064	3	Loom Clamp
	851-3816-1Z	3	3/8"-16 x 1" Cap Screw
	815-3816-Z	3	3/8"-16 Nylon Insert Lock Nut
7	155-2603-06-06-06	2	Tee
8	55-0324	2	Compact Twin Series Clamp
	815-3816-Z	2	3/8"-16 Nylon Insert Lock Nut
	851-3816-2.25Z	2	3/8"-16 x 2-1/4" Cap Screw
	805-0038-Z	2	3/8" Flat Washer
9	155-04R17-56-1	2	1/4" x 56" Hose Assembly
10	155-7002-06-04	4	Straight Adapter
11	155-JB06-06	2	Straight Adapter
12	155-2406-06-06	2	Straight Adapter
13	155-04R17-15-1	2	1/4" x 15" Hose Assembly
14	155-6602-06-06-06	2	Tee
15	155-04R17-197-1	2	1/4" x 197" Hose Assembly

# HSTS30 HLC BRAKE HYDRAULIC SYSTEM

Bottom View

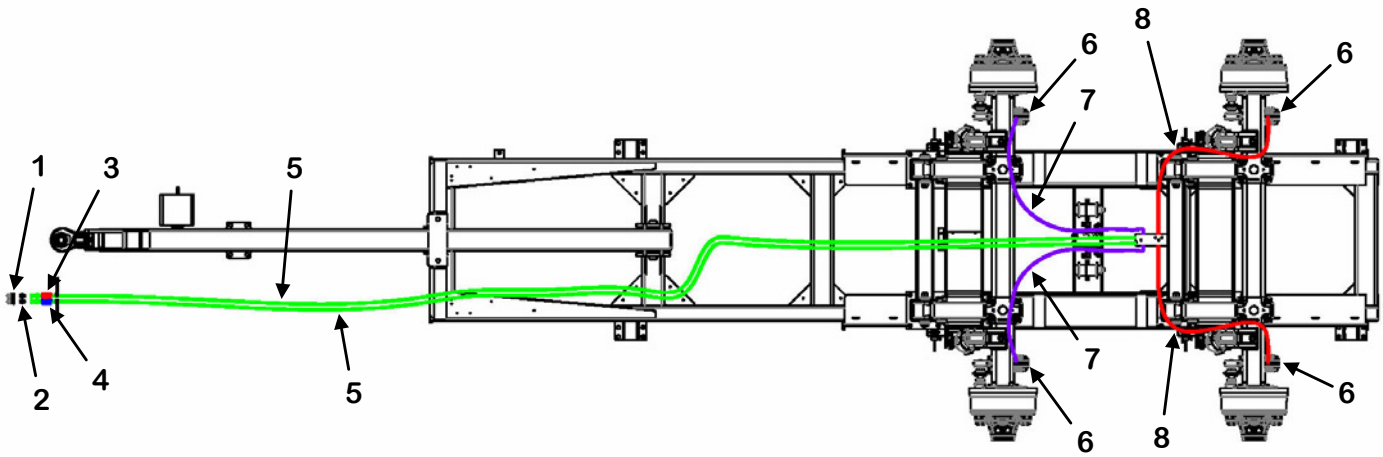

<b>KEY</b>	<b>PART NUMBER</b>	<b>QTY</b>	<b>DESCRIPTION</b>
1	155-8010-15	2	ORB Male Tip
2	155-6400-6-8	2	Straight Adapter
3	32-0053	7	Red Cable Tie
4	32-0054	7	Blue Cable Tie
5	155-04R17-373-1	2	1/4" x 373" Hose Assembly
6	155-7202-06-06	4	90° Elbow
7	155-04R17-74-1	2	1/4" x 74" Hose Assembly
8	155-04R17-58-1	2	1/4" x 58" Hose Assembly

# HSTS30 HLC BRAKE MANIFOLD

Left View

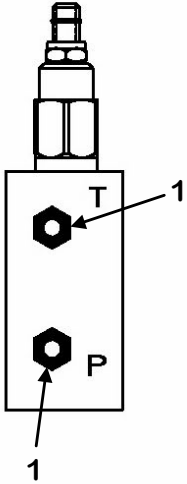

Bottom View

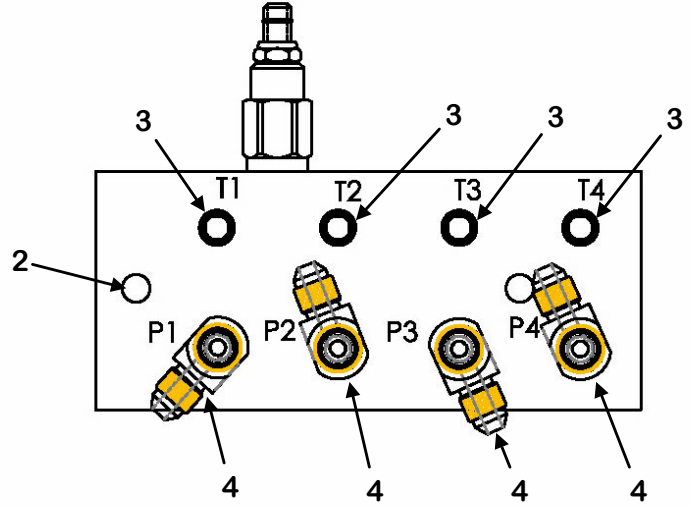

Brake Manifold Detail  
Bottom View

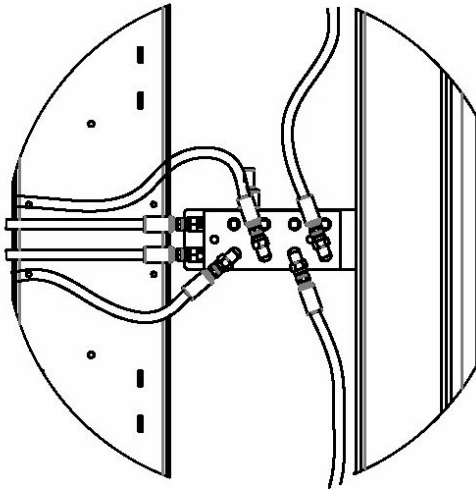

<b>KEY</b>	<b>PART NUMBER</b>	<b>QTY</b>	<b>DESCRIPTION</b>
1	155-2404-06-04	2	Straight Adapter
2	851-3118-2.25Z	2	5/16"-18 x 2-1/4" Cap Screw
	815-3118-Z	2	5/16"-18 Nylon Insert Lock Nut
3	55-0167	4	1/4" Plug
4	155-2501-06-04	4	90° Elbow

# HSTS45 HLC BRAKE HYDRAULIC SYSTEM

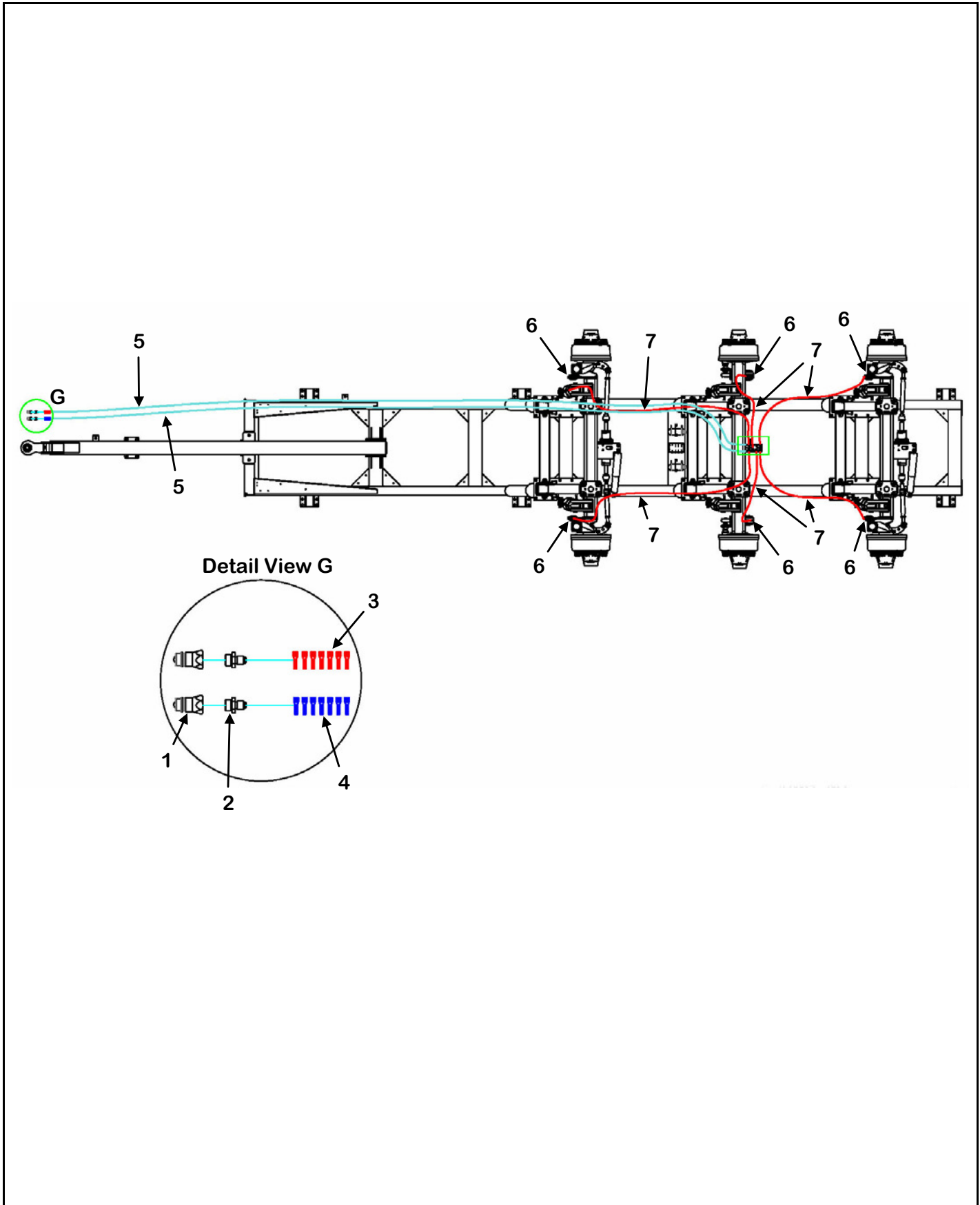

<b>KEY</b>	<b>PART NUMBER</b>	<b>QTY</b>	<b>DESCRIPTION</b>
1	155-8010-15	2	ORB Male Tip
2	155-6400-6-8	2	Straight Adapter
3	32-0053	7	Red Cable Tie
4	32-0054	7	Blue Cable Tie
5	155-04R17-382-1	2	1/4" x 382" Hose Assembly
6	155-7202-06-06	6	90° Elbow
7	155-04R17-102-1	6	1/4" x 102" Hose Assembly

# HSTS45 HLC BRAKE MANIFOLD

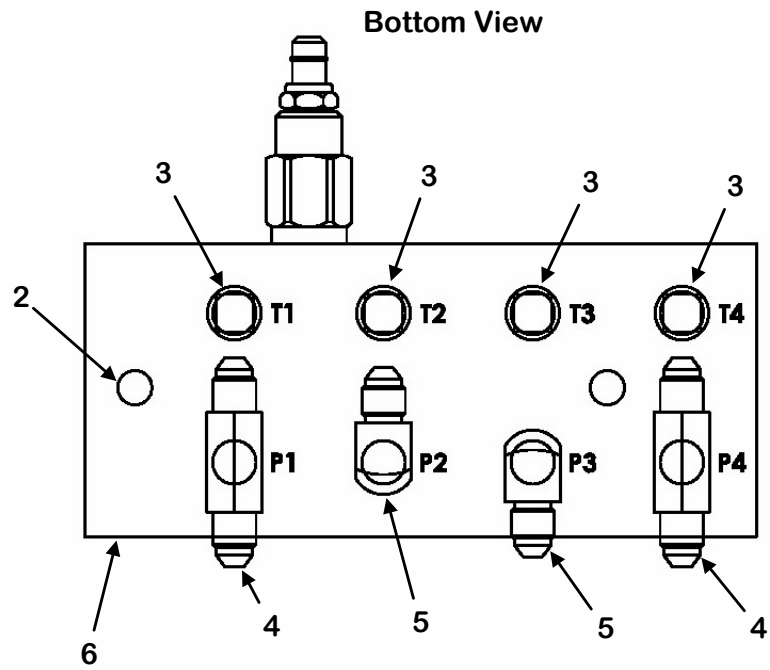
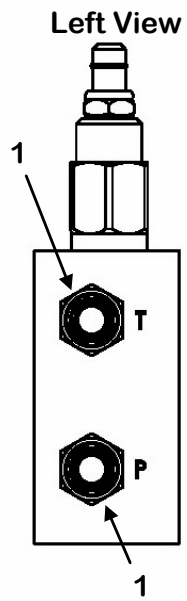



<b>KEY</b>	<b>PART NUMBER</b>	<b>QTY</b>	<b>DESCRIPTION</b>
1	155-2404-06-04	2	Straight Adapter
2	851-3118-2.5Z	2	5/16"-18 x 2-1/2" Cap Screw
	815-3118-Z	2	5/16"-18 Nylon Insert Lock Nut
3	55-0167	4	1/4" Plug
4	155-2601-06-06-04	2	Tee
5	155-2501-06-04	2	90° Elbow
6	57-0046	1	Relief Valve Manifold Block

# HSTS30 CONTROL BOX ELECTRICAL

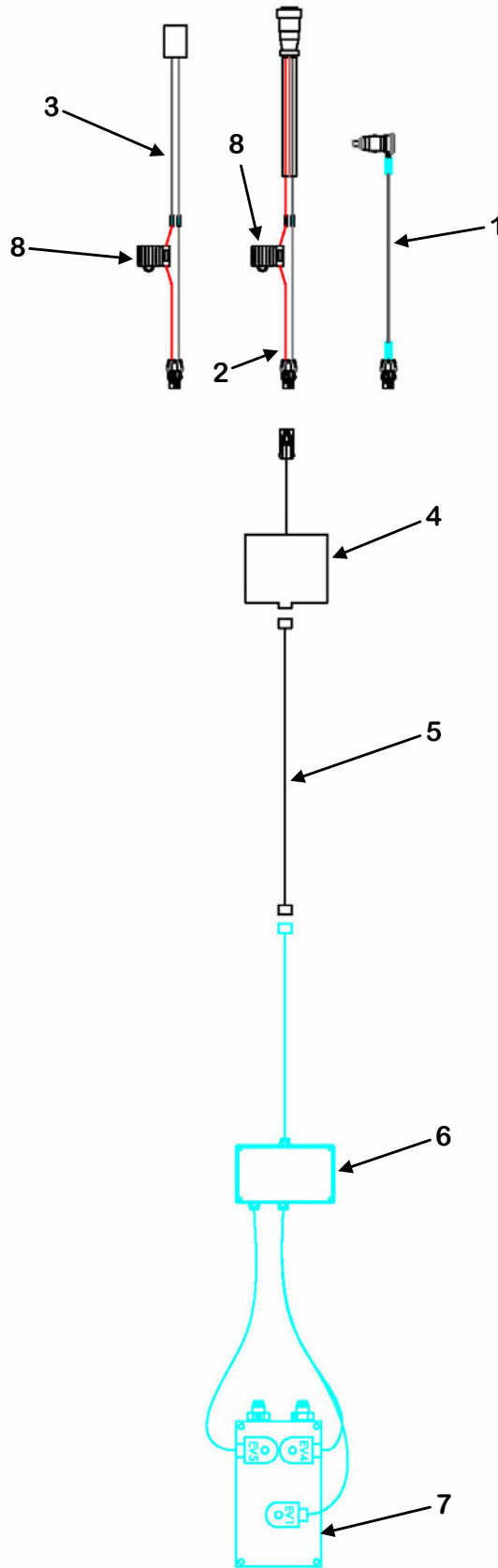

<b>KEY</b>	<b>PART NUMBER</b>	<b>QTY</b>	<b>DESCRIPTION</b>
0	675-0003	1	Control Kit (Excludes Key #5) (Prior to 2023 Model Year)
	675-0004	1	Control Kit (Excludes Key #5) (2023 Model Year & Later)
1	56-0360	1	Auxiliary Power Cord Assembly
2	56-0361	1	Auxiliary 3-Pin Power Assembly
3	56-0362	1	Auxiliary Fendt Power Cord Assembly
4	56-0426	1	Control Box Assembly
5	56-0424	1	28' J-Box To Control Box Wire Assembly
6	675-0003-3	1	Junction Box Assembly With Cables (Prior To 2023 Model Year)
	675-0004-4	1	Junction Box Assembly With Cables (2023 Model Year & Later)
7	See Page 50	1	Hydraulic Manifold
8	156-78105	1	Fuse

# HSTS45 CONTROL BOX ELECTRICAL

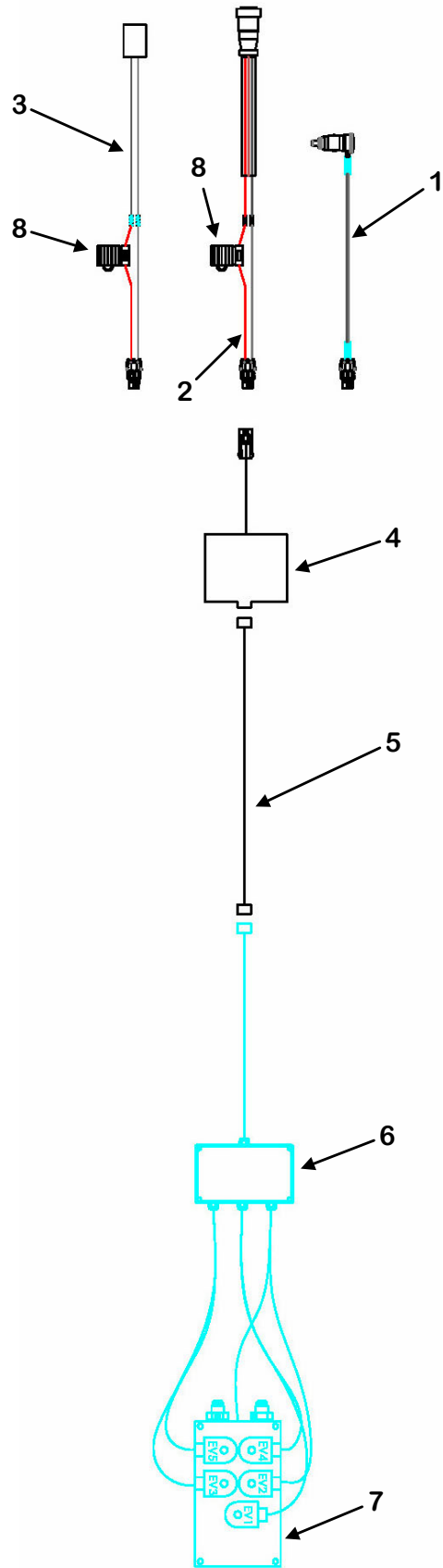

<b>KEY</b>	<b>PART NUMBER</b>	<b>QTY</b>	<b>DESCRIPTION</b>
0	675-0003	1	Control Kit (Excludes Key #5)
1	56-0360	1	Auxiliary Power Cord Assembly
2	56-0361	1	Auxiliary 3-Pin Power Assembly
3	56-0362	1	Auxiliary Fendt Power Cord Assembly
4	56-0426	1	Control Box Assembly
5	56-0424	1	28' J-Box To Control Box Wire Assembly
6	675-0003-3	1	Junction Box Assembly With Cables
7	See Page 54	1	Hydraulic Manifold
8	156-78105	1	Fuse



# 10.0 SPECIFICATIONS

<b>DIMENSIONS / SPECIFICATIONS</b>		
<b>MODEL:</b>	<b>HSTS30</b>	<b>HSTS45</b>
Frame	4x8 Tubing	4x8 Tubing
Capacity (Trailer/Spreader/Load)	48,000 Lbs	90,000 Lbs
Axle Configuration	Tandem - Non Steer	Tridem - Steerable F&R
	25,000 Lbs x 2	33,000 Lbs x 3
	Sliding Hydraulic Suspension	Fixed Hydraulic Suspension
Heavy Duty Hubs	Grease Filled - 10 Bolt	Grease Filled - 10 Bolt
Articulating Implement Hitch	Std - Requires 1.5" or 2" pin Hammerstrap Style Hitch	Std - Requires 1.5" or 2" pin Hammerstrap Style Hitch
Poly Fender Liner	Standard	Standard
Steel Fender Flares	Optional	Optional
Tire Options	w/710/50xR26.5 High Flotation	w/710/50xR26.5 High Flotation
	800/45Rx26.5 High Flotation	800/45Rx26.5 High Flotation
Brakes (Hyd Hand or Foot Pedal)	Optional	Standard
Safety Chain/SMV	Optional	Optional
Tracks in Lieu of Tires	Call	Call













**Manufactured by:  
Meyer Manufacturing  
Corporation**

674 W. Business Cty Rd A

Dorchester, WI 54425

Phone. 1-800-325-9103

Fax: 715-654-5513

Email: [parts@meyermfg.com](mailto:parts@meyermfg.com)

Website: [www.meyermfg.com](http://www.meyermfg.com)